

30 HILL ROAD

ROSS, CA 94957

Initial
SRF

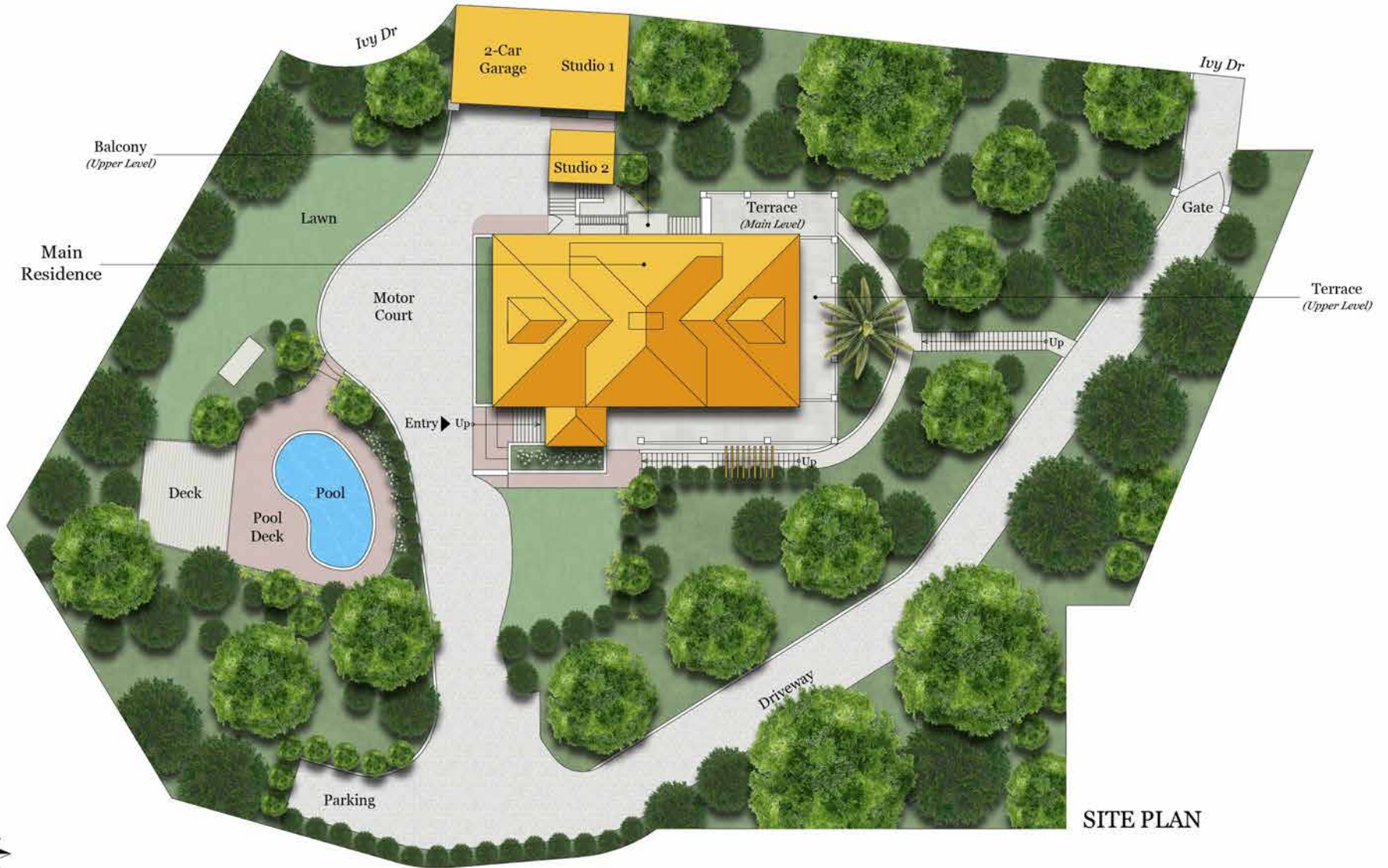

SITE PLAN



30 HILL ROAD

ROSS, CA 94957

Estimated Total Finished
Square Footage: 6,900 SQ FT

Above-Grade: 5,030 SQ FT Below-Grade: 1,870 SQ FT
Calculated per ANSI Standard Z765-2021

- Main Residence: 6,485 SQ FT
 - First Floor: 1,870 SQ FT
 - Second Floor: 2,380 SQ FT
 - Third Floor: 1,830 SQ FT
 - Loft: 405 SQ FT
- Studio 1: 295 SQ FT
- Studio 2: 120 SQ FT

Unfinished Square Footage: 2,040 SQ FT

- Storage (Main Residence-Basement): 1,300 SQ FT
- Storage (Main Residence-First Floor): 35 SQ FT
- Third Floor (Main Residence-Low Ceiling): 315 SQ FT
- Detached 2-Car Garage: 390 SQ FT

Estimated Total Finished & Unfinished
Square Footage: 8,940 SQ FT

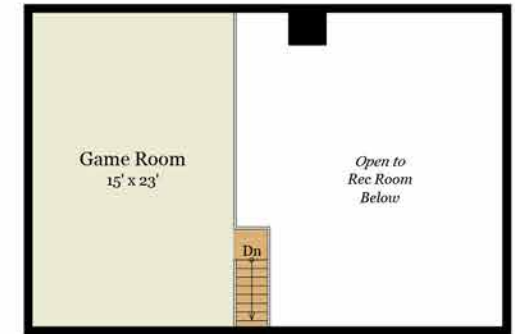

MAIN RESIDENCE
LOFT
405 SQ FT



MAIN RESIDENCE
SECOND FLOOR
2,380 SQ FT



MAIN RESIDENCE
THIRD FLOOR
1,830 SQ FT - Finished
315 SQ FT - Low Ceiling



30 HILL ROAD

ROSS, CA 94957

