

Estimated Total
Finished Square Footage: 2,650 SQ FT

Calculated from outside face of exterior walls and
center line of demising walls.

- #263: 915 SQ FT
- #265: 1,735 SQ FT

Plus 1,695 SQ FT Common Area

*Estimated Total Finished & Unfinished Square Footage : 4,345 SQ FT

263 & 265 DIVISO STREET

TIBURON, CA 94920



MAIN LEVEL

#265: 1,735 SQ FT



LOWER LEVEL 1

#263: 915 SQ FT
Common Area: 155 SQ FT

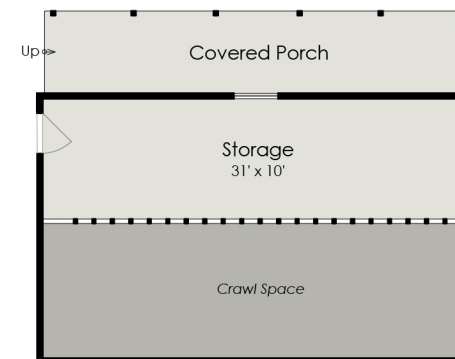

LOWER LEVEL 2

Common Area: 310 SQ FT

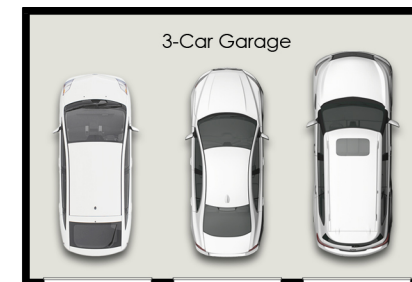

DETACHED GARAGE

Common Area: 615 SQ FT

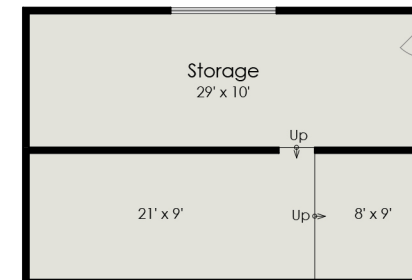

SHED (BELOW GARAGE)

Common Area: 615 SQ FT



263 & 265 DIVISO STREET

TIBURON, CA 94920

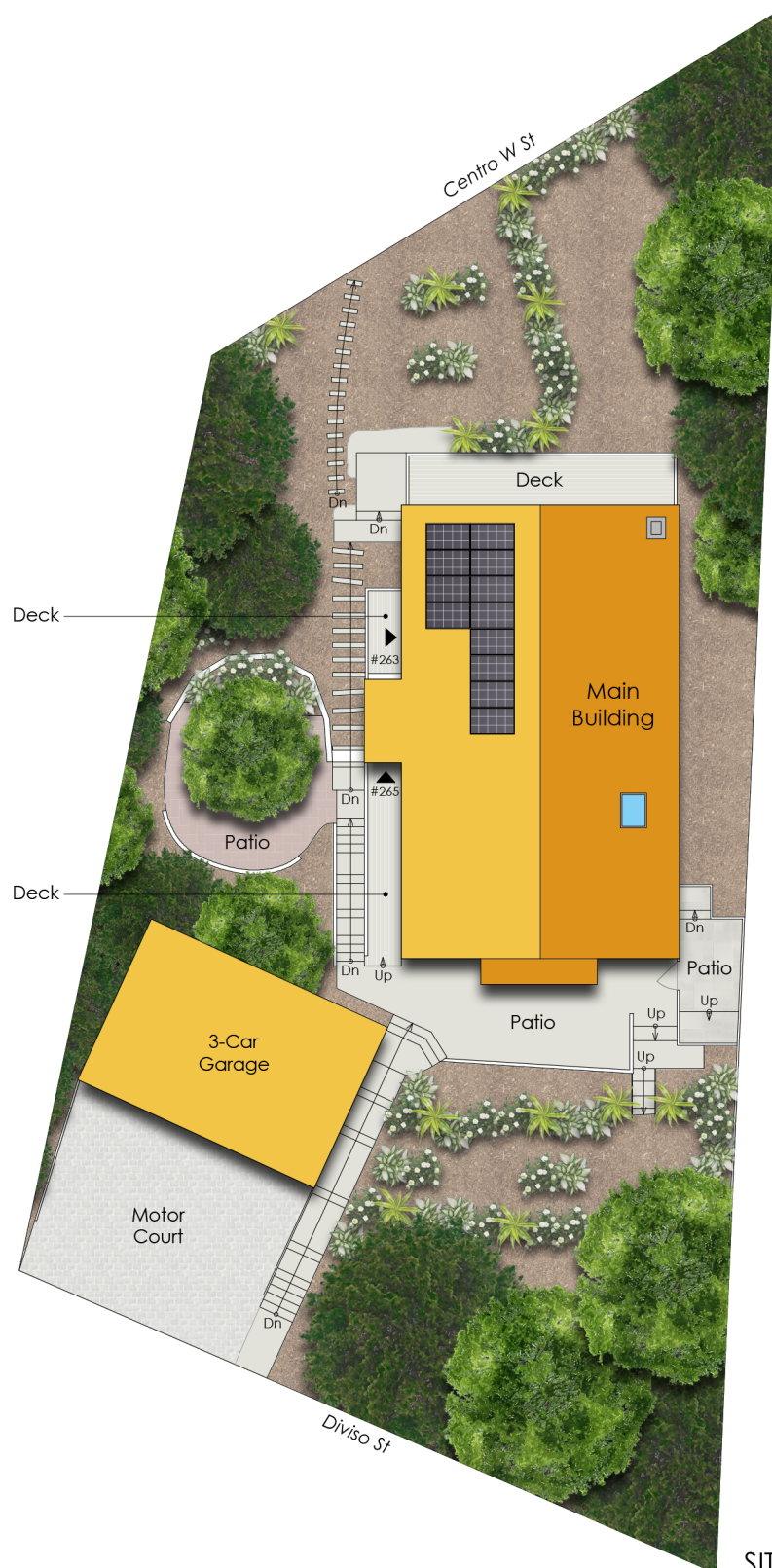

SITE PLAN

