

1960 STRAITS VIEW DRIVE

TIBURON, CA 94920

SITE PLAN



TIBURON, CA 94920





1960 STRAITS VIEW DRIVE

TIBURON, CA 94920



Estimated Total Finished
Square Footage: 10,365 SQ FT

Above-Grade: 4,935 SQ FT Below-Grade: 5,430 SQ FT

• Main Residence: 8,720 SQ FT

Main Level: 4,935 SQ FT

Lower Level: 3,785 SQ FT

• Guest House: 1,120 SQ FT

• Pool House/Office: 525 SQ FT

Plus 1,065 SQ FT Detached 4-Car Garage

Plus 160 SQ FT Mech Room (Main Residence - Lower Level)

Plus 620 SQ FT Storage (Main Residence - Lower Level)

Plus 10 SQ FT Mech Room (Pool House)

Plus 60 SQ FT Storage (Guest House - Main Level)

Plus 80 SQ FT Mech Room (Guest House - Main Level)

Plus 350 SQ FT Storage (Guest House - Lower Level)

Plus 90 SQ FT Pool Mech

Calculated per ANSI Standard Z765-2003

* Estimated Total Finished & Unfinished Square Footage: 12,800 SQ FT



1960 STRAITS VIEW DRIVE

TIBURON, CA 94920

Partial Lot Shown

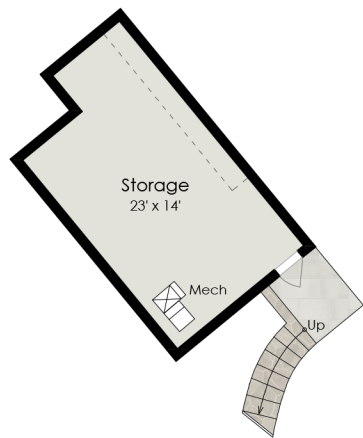

GUEST HOUSE
LOWER LEVEL
350 SQ FT

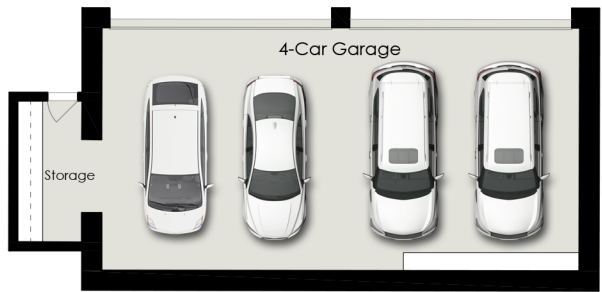

DETACHED GARAGE
1,065 SQ FT