

2698 Cortina Residence - Interiors

BERGLUND Architects, LLC

2698 Cortina Residence – Finish Schedule

BERGLUND Architects, LLC

2698 CORTINA RESIDENCE INTERIOR FINISH SCHEDULE

Last Updated: 9/25/19

BEAMS

All Steel Beams Waxed Finish

CEILINGS

All Ceiling Finishes (UNO) Drywall

FLOOR COVERINGS

Typ Carpet Spec	Caravan Carpets - Cambria - Decorative Flooring	sent out for pricing 8/26/19
	Stone	
Typ Wood Spec	Como	Arrigoni to provide similar
Garage Floor	Concrete	RE: Sample at HBA Office
Flagstone	Buff Flagstone	
Tile	See Tile/ Slab/ Plumbing/ Cabinet by Room Below	

Flooring @ all rooms (UNO) Wood

LOWER LEVEL

Family Room	Carpet
Laundry	Tile
Bedroom 2/ Closet 2	Carpet
Bathroom 2	Tile
Bedroom 3/ Closet 3	Carpet
Bathroom 3	Tile
Mech/ Storage	Concrete

MAIN LEVEL

Entry	Flagstone
Mud Room	Flagstone
Powder Room	Wood
Office	Wood
Living Room	Wood
Dining Room	Wood
Kitchen	Wood
Master Bedroom	Carpet
Master Closet	Carpet
Master Bath	Tile

UPPER LEVEL

Upper Family Room/ Closet	Carpet
Bedroom 4/ Closet 4	Carpet
Bathroom 4	Tile
Bedroom 5/ Closet 5	Carpet
Bathroom 5	Tile

WALL FINISH

All Walls (UNO) Drywall Level 4 - Very Light Skip Trowel

DOORS/ DOOR HARDWARE

Panel	TBD
Hardware	TBD
Entry Door Handle (both sides)	TBD

2698 CORTINA RESIDENCE INTERIOR FINISH SCHEDULE

CABINETS & BUILT-INS/ HARDWARE (also listed by room below)			
Kitchen - Cabinet A	Wood Laminate	Porcelanosa	Sugi Ice
Kitchen - Cabinet B	White Acrylic	Porcelanosa	See Character Image
Kitchen - Cabinet C	Blue Drawers	Porcelanosa	See Character Image
Master Bath, Bath 3, Powder	Rift Cut White Oak	Genesis	RE: Sample at HBA Office
Laundry, Bath 2, Wet Bar	Wood Laminate	Cleaf (or similar brand)	LG99 "Teak" Matrix
Mud Room, Bath 4, Bath 5	Wood Laminate	Cleaf (or similar brand)	LK55 "Palissandro" Matrix

APPLIANCES				
		Manufacturer	Model #	
Laundry	4.4 Cu. Ft. Front Load	Electrolux	EFLS627U TT/IW	
	8.0 Cu. Ft. Front Load Dryer	Electrolux	EFME527U TT/IW	
Kitchen	48" Side by Side Refrigerator/ Freezer	SubZero	BI-48S/O	
	48" Dual Fuel Range, 6 burner + Griddle	Wolf	DF486G	
	Hood / Hood Liner	Custom	S.S.	
	24" Dishwasher	Cove	DW2450	
	30" Microwave Oven w/ Drop Down Door	Wolf	MDD30PM/S/PH	Microwave Only (No Steam)

TILE/ SLAB/ PLUMBING FIXTURES

LOWER LEVEL

WET BAR				
Tile and Slabs	Notes	Manufacturer	Description	Notes/size
Slab A	Counter Top & Backsplach		Marble/ Quartzite	Remnant
Plumbing	Manufacturer	Description	Model #	
Sink	1 Julien - Pro Chef	16" x 16" x 10" Stainless Steel Undermount	IH75-US-181810	
Faucet	1 Grohe	Concetto pull-out dual spray	32665003	StarLight Chrome
Cabinets	Manufacturer	Description	Model #	Notes/size
	Cleaf (or similar brand)	Wood Laminate	LG99 "Teak" Matrix	

LAUNDRY				
Tile and Slabs	Notes	Manufacturer	Description	Size
Tile A	Floor	Ergon (Contact: Michael Montorsi (630) 539-4470 mmontorsi@m2ilt.com	Stone Talk Sand Martella	12" x 24"
Slab A	Counter Top and Backsplash	Ceaserstone	White	3cm
Plumbing	Manufacturer	Description	Model #	
Sink	1 Julien	21" x 16" x 12" Stainless Steel Undermount Utility	003972 J7	
Faucet	1 Grohe	Concetto pull-out dual spray	32665003	StarLight Chrome
Cabinets	Manufacturer	Description	Model #	Notes/size
	Cleaf (or similar brand)	Wood Laminate	LG99 "Teak" Matrix	

2698 CORTINA RESIDENCE INTERIOR FINISH SCHEDULE

BATHROOM 2

Tile and Slabs		Notes	Manufacturer	Description	Notes/size
Tile A		Floor	Ergon (Contact: Michael Montorsi (630) 539-4470 mmontorsi@m2ilt.com)	Stone Talk Sand Martella	12" x 24"
Tile B		Wall		Stone Talk White Rullata	12" x 24"
Slab A		Counter Top & Backsplash		Ceaserstone Cosmopolitan White	3cm
Plumbing		Manufacturer	Description	Model #	
faucet	1	Porcelanosa - Noken	TONO: Rib Single Handle	N122030063-100225000	Chrome
sink	1	Porcelanosa - Noken	Sotto: Under-mount	N396990867-100120592	
shower head	1	Speakman	Icon Shower Head	S-2251	
shower control	1	Porcelanosa - Noken	Hotel: Pressure Balance	N194710566-100234027	Chrome
shower drain toilet	1	Schluter - Kerdi-Drain Porcelanosa - Noken	4" Square Tilable Grate Architect: One-piece	KD4 GRK ECS N301512843-100111657	4" x 4"
Cabinets		Manufacturer	Description	Model #	Notes/size
		Cleaf (or similar brand)	Wood Laminate	LG99 "Teak" Matrix	

BATHROOM 3

Tile and Slabs		Notes	Manufacturer	Description	Size
Tile A		Floor	Stone and More	2.0 Matte Zecevo	11 3/4"x23 5/8"
Tile B		Wall	Stone and More	2.0 Matte Zecevo	11 3/4"x23 5/8"
Slab A		Counter Top	LG Hausy	Cirrus	3 cm
Plumbing		Manufacturer	Description	Model #	
faucet	1	Porcelanosa - Noken	TONO: Rib Single Handle in Chrome	N122030063-100225000	Chrome
sink	1	Porcelanosa - Noken	Sotto: Under-mount	N396990867-100120592	17 29/32" X 13 3/8"
shower head	1	Speakman	Icon Shower Head	S-2251	
shower hand/ bar/ hose	1	Porcelanosa - Noken	Mood: Shower Pack	N199999424-100144945	Chrome
shower control	1	Porcelanosa - Noken	URBAN: 3 way Thermostatic Valve	N111390022-100104972	Chrome
shower drain toilet	1	Schluter - Kerdi-Drain Porcelanosa - Noken	4" Square Tilable Grate Architect: One-piece	KD4 GRK ECS N301512843-100111657	4" x 4"
Cabinets		Manufacturer	Description	Model #	Notes/size
		Genesis	Rift Cut White Oak		RE: Sample at HBA Office

2698 CORTINA RESIDENCE INTERIOR FINISH SCHEDULE

POWDER ROOM

Tile and Slabs		Notes	Manufacturer	Description	Notes/size
Slab A		Counter Top	Similar to *see Character image	Remnant Stone Slab	
Tile A		Accent Wall around Mirror	Waterworks	Keystone Decorative	Carlotta 4" x 18"
Plumbing		Manufacturer	Description	Model #	
sink	1	Kohler	Sotto: Under-mount	N396990867-100120592	17-29/32" x 13-3/8"
faucet	1	Porcelanosa - Noken	Tono single control wall mount	N122030058-100224921	Chrome
toilet	1	Porcelanosa - Noken	ARQUITECT: Wall-mount	N390000046-100144090	
flush button	1	Porcelanosa - Noken	SMART LINE: Double Flush Button	N386000011-100104449	White
Cabinets		Manufacturer	Description	Model #	Notes/size
		Genesis	Rift Cut White Oak		RE: Sample at HBA Office

MAIN LEVEL

KITCHEN

Tile and Slabs		Notes	Manufacturer	Description	Notes/size
Slab A		Counter Top/ Backsplash	Ceaserstone	Cosmopolitan White	3 cm
Slab B		Island/ Behind Range	natural quartzite	Taj Mahal	3 cm
Plumbing		Manufacturer	Description	Model #	
Main Kitchen Sink	1	Julien Smartstation	36" x 18-1/8" x 10" Undermount	005453	Stainless Steel with Walnut Accessories
Main Kitchen Disposal	1	Insinkerator (air switch)	3/4 HP Disposer		
Main Kitchen Faucet	1	Waterstone	Contemporary Pull-down	5700	chrome
Island Sink	1	Julien - Pro Chef	16" x 16" x 10" Stainless Steel Undermount	IH75-US-181810	
Island Disposal	1	Insinkerator (air switch)	3/4 HP Disposer		
Island Faucet	1	Grohe	Concetto pull-out dual spray	32665003	chrome
Cabinets		Manufacturer	Description	Color	Notes/size
Kitchen - Cabinet A		Porcelanosa	Wood Laminate	Sugi Ice	
Kitchen - Cabinet B		Porcelanosa	White Acrylic	See Character Image	
Kitchen - Cabinet C		Porcelanosa	Blue Drawers	See Character Image	

2698 CORTINA RESIDENCE INTERIOR FINISH SCHEDULE

MASTER BATHROOM

Tile and Slabs	Notes	Manufacturer	Description	Notes/size
Tile A	Floor/ Wall/ Base	Stone and More/ Decorative Materials	2.0 Calacatta Black	11 3/4"x23 5/8"
Tile B	Shower Wall	Bianco Carrarra/ Decorative Materials	Honed Dune	6"x24"
Slab A	Counter Top/ Backsplash/ Window Sill	Ceaserstone	Organic White	3cm
Plumbing	Manufacturer	Description	Model #	
sink	2 Kohler			
faucet	2 Porcelanosa - Noken	LOUNGE: Single control Chrome	N199999465-100143790	Chrome
shower head	1 Speakman	Icon Shower Head	S-2251	
shower hand/ bar/ hose	1 Porcelanosa - Noken	NK CONCEPT: Shower pack	N112080006-100158886	Chrome
shower control	1 Porcelanosa - Noken	LOUNGE: Thermostatic Trim	N196599520-100104656	Chrome
shower control	2 Porcelanosa - Noken	LOUNGE: Volume Trim	N196599521-100104655	Chrome
shower drain	Schluter - Kerdi-Line	Frameless tileable	KL1DRE 140	55-1/8" Chrome
free standing tub	1 Signature Hardware	Leith Acrylic	920161	61"
tub filler	1 Porcelanosa - Noken	LOUNGE: Freestanding - Chrome	N199999463-100143737	Chrome
toilet	1 Porcelanosa - Noken	Arquitect: One-piece	N301512843-100111657	
Cabinets	Manufacturer	Description	Model #	Notes/size
	Genesis	Rift Cut White Oak		RE: Sample at HBA Office

BATHROOM 4

Tile and Slabs	Notes	Manufacturer	Description	Notes/size
Tile A	Floor/ Wall	Ergon (Contact: Michael Montorsi (630) 539-4470 mmontorsi@m2ilt.com	Stone Talk Sand Martella	12" x 24"
Tile B	Shower Wall	Sudway Lab by Wow/ Decorative Materials	Mini Hexa Canale	6" x 7", 2cm
Slab A	Counter Top	LG Hausy	Ice White Matte Cirrus	3cm
Plumbing	Manufacturer	Description	Model #	
faucet	1 Porcelanosa - Noken	TONO: Rib Single Handle in Chrome	N122030063-100225000	Chrome
sink	1 Porcelanosa - Noken	Sotto: Under-mount	N396990867-100120592	17 29/32" X 13 3/8"
shower head	1 Speakman	Icon Shower Head	S-2251	
shower control	1 Porcelanosa - Noken	URBAN: 3 way Thermostatic Valve	N111390022-100104972	Chrome
shower drain	Schluter - Kerdi-Drain	4" Square Tilable Grate	KD4 GRK ECS	4" x 4"
toilet	1 Porcelanosa - Noken	Arquitect: One-piece	N301512843-100111657	
Cabinets	Manufacturer	Description	Model #	Notes/size
	Cleaf (or similar brand)	Wood Laminate	LK55 "Palissandro" Matrix	

2698 CORTINA RESIDENCE INTERIOR FINISH SCHEDULE

BATHROOM 5

Tile and Slabs		Notes	Manufacturer	Description	Notes/size
Tile A		Floor	Ergon (Contact: Michael Montorsi (630) 539-4470 mmontorsi@m2ilt.com)	Stone Talk Sand Martella	12" x 24"
Tile B		Wall		Stone Talk White Rullata	12" x 24"
Slab A		Counter Top		Ceaserstone Cosmopolitan White	3cm
Plumbing		Manufacturer	Description		Model #
faucet	1	Porcelanosa - Noken	TONO: Rib Single Handle in Chrome		N122030063-100225000
sink	1	Porcelanosa - Noken	Sotto: Under-mount		N396990867-100120592
shower head	1	Speakman	Icon Shower Head		S-2251
shower/ tub control/ diverter	1	Porcelanosa - Noken	Hotels: Pressure balance with Diverter		N194710603-100234034
tub filler	1	Porcelanosa - Noken	Round Tub Spout		N299998565-100229055
bathtub	1	MTI	Cameron 1 - 60" x 32"		151
toilet	1	Porcelanosa - Noken	Arquitect: One-piece		N301512843-100111657
Cabinets		Manufacturer	Description	Model #	Notes/size
		Cleaf (or similar brand)	Wood Laminate	LK55 "Palissandro" Matrix	

BATH ACCESSORIES			
	Manufacturer	Description	Model #
Towel Ring	TBD		
Toilet Roll	TBD		
Robe Hook	TBD		
Single Towel Rail	TBD		

2698 Cortina Residence - Flooring

BERGLUND Architects, LLC



LOGIN

creativefloors

como



SPECIFICATIONS

- Wide Plank Floor: Como 8000-15
- Species: Oak
- Plank Width: 8"
- Finish: Natural Oil
- Construction: Engineered
- Color is Baked Through Entire Veneer
- Residential or Commercial Use
- Installed in The Four Seasons Remedy Bar in Vail

PROJECTS WITH THIS FLOOR



Como in Remedy Bar Vail



Como in Beaver Creek

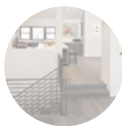

[PROJECTS](#) [OUR PROCESS](#)

creativefloors

[PRODUCTS](#) [CONTACT US](#)



como in remedy bar vail

Caravan Carpets



Cambria - Stone

Cambria uses natural undyed wool and is finished with a random shear to give it a beautiful distressed look and feel. Like Orleans, Cambria's versatile design makes it at home in many settings and rooms both in wall to wall carpet and in beautiful area rugs.

Rug Fabrication Available

Content - 100% Fine Long Staple Wool

Construction - Hand Loomed

Backing - Action Backed

Width - 15'

2698 Cortina Residence – Cabinet/ Tile/ Solid Surface
BERGLUND Architects, LLC



PALATE



SLAB A



TILE A



TILE B



CABINET



PALATE



SLAB A



TILE A

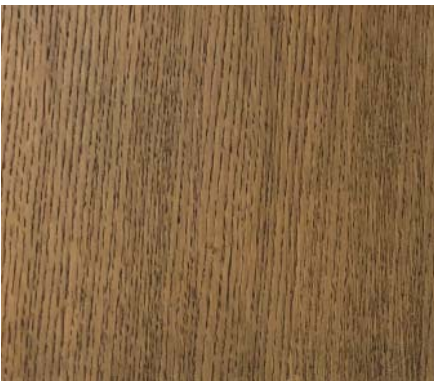

CABINET

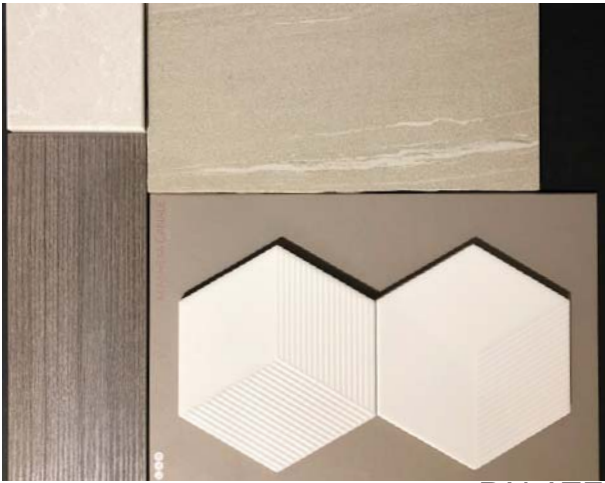

PALATE



SLAB A



TILE A

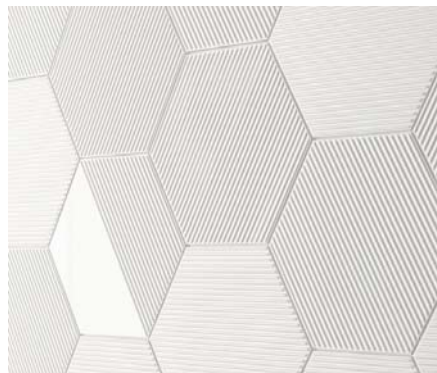

TILE B



CABINET



PALATE



SLAB A



TILE A



TILE B



CABINET



PALATE



SLAB A



TILE A



TILE B



CABINET



PALATE



SLAB A



TILE A



TILE B



CABINET



PALATE



SLAB A



SLAB B



CABINET A



CABINET B



CABINET C



2698 Cortina Residence - Appliances

BERGLUND Architects, LLC

FRONT LOAD WASHER

4.4 Cu. Ft.

EFLS627U TT / IW

Perfect Steam™ Washer with LuxCare® Wash, SmartBoost™ and IQ-Touch™ Controls



SIGNATURE FEATURES



THE MOST EFFECTIVE STAIN-REMOVING WASHER WITH SMARTBOOST™

Unlike other washers, our washer with SmartBoost™ premixes water and detergent before the cycle begins, maximizing the cleaning power of the detergent.



WORLD'S 1ST ADAPTIVE DISPENSER™ DESIGNED TO ACCEPT PODS®

Get the ultimate clean no matter what type of detergent you prefer with the Adaptive Dispenser™.



PERFECT STEAM™ REMOVES TOUGH STAINS

Unlike many washers, our Perfect Steam™ rises from the bottom, gently lifting dirt and stains from fibers.



THOROUGH CLEANING WITH THE LUXCARE® WASH SYSTEM

Our LuxCare® Wash System offers a thorough clean with improved wash actions, temperature control, and smart load sensing.

PRODUCT DIMENSIONS

Height	38"
Width	27"
Depth	32"

MORE EASY-TO-USE FEATURES

15-MINUTE FAST WASH¹

Quickly deep cleans the items you need most.

SOLID SOIL LEVEL CLEANS CAKED-ON STAINS

The solid soil level gives you a deeper clean to get rid of those tough stains that get caked on, like mud or dirt.

SANITIZE OPTION

Certified to kill and remove 99% of bacteria and 95% of allergens.²

STAINSOAK™ OPTION ELIMINATES PRE-TREAT

Unlike other washers, it starts by premixing water, detergent, and stain remover before the cycle begins to create a powerful, yet gentle cleaning solution. Then, the temperature, tumbling actions, and time are optimized based on the stain you select.

ENERGY STAR®-CERTIFIED

Electrolux washers meet strict criteria to guarantee high-quality energy efficient performance — without sacrificing clean.

ACTIVWEAR CYCLE

Takes care of delicate and expensive activewear garments.

10-YEAR MOTOR WARRANTY PLUS LIFETIME TUB WARRANTY

Rest easy knowing your washer is backed by a 10-year motor and lifetime tub warranty.

PERFECT BALANCE® SYSTEM & SECOND FLOOR GUARANTEE

Balances loads for smooth, quiet operation. So quiet you can even run your washer on the second floor or near bedrooms without noticing it.³

FITS MORE ROOMS WITH REVERSIBLE WASHER DOOR

With reversible washer door, four-way venting, and a standard 27" platform, our products are designed to fit just about anywhere you want to put them.

EXTRA LARGE CAPACITY

Easily cleans a king-sized comforter with extra large 4.4 cu. ft. drum.

Available in:



Titanium
(TT)



Island White
(IW)

¹Fast time based on 3 lb. DOE load.

²Our products meet the NSF® testing standards.

³As tested on conventional wood floor construction with vinyl floor covering.

FRONT LOAD WASHER

EFLS627U TT/IW



27" FRONT LOAD WASHER

Capacity D.O.E. 4.4 Cu. Ft.

FEATURES

Pull-to-Open Door	Yes
IQ-Touch™ Controls	Yes
Perfect Steam™ Wash System	Yes
Balance System	Perfect Balance®
Sound System	Luxury-Quiet™
Lighting	Luxury-Design®
Adaptive Dispenser™	Yes
Wash System	LuxCare®
Integral Water Heater	Yes
Wash Drum	Stainless Steel
Automatic Temperature Control	Yes
Automatic Water Level Adjustment	Yes
Auto Prewash Detergent Dispenser (Liquid/Powder)	Yes
Auto Bleach Dispenser (Liquid Only)	Yes
Auto Detergent Dispenser (Liquid/Powder/PODS®)	Yes
Auto Fabric Softener Dispenser (Liquid Only)	Yes
Tumble Speed (RPM)	Variable
Spin Speed (RPM)	1,300
Reversible Door	Yes
Adjustable Leveling Legs	Yes
ENERGY STAR®	Yes
NSF® Certified/Sanitize	Yes

CYCLES

Heavy Duty, Whitest Whites, Normal, Activewear, Colors, 15-Min. Fast Wash, Delicates, Rinse & Spin, Clean Washer	9
--	---

OPTIONS

Wash/Rinse Temperature Combinations	7
Temperature Selections	5
Add Steam	Yes
Spin Speed Selections	5
Soil Level Selections	5
Delay Start	Yes
End-of-Cycle Chime	On/Off

INSTALLATION OPTIONS

Freestanding, Under Counter*, Stacked (Under Dryer), Pedestal, Hidden (In Closet), Second Floor	Yes
---	-----

ACCESSORIES

Luxury-Glide® Pedestal with Spacious Storage Drawer—Titanium — PN # EPWD257UTT	Optional
Island White — PN # EPWD257UIW	Optional
Dryer Stacking Kit — PN # STACKIT7X	Optional
Drain Hose Extension Kit — PN # 137098000	Optional

SPECIFICATIONS

Color —	
Titanium	TT
Island White	IW
Power Supply Location	Top Right Rear
Water Inlet Location	Top Left Rear
Voltage Rating	120V/60 Hz
Connected Load (kW Rating) @ 120 Volts†	1.2
Watts @ 120 Volts	1,200
Amps @ 120 Volts	12
Shipping Weight (Approx.)	247 Lbs.

*Side-by-Side units in under-counter installation require custom-built countertop and/or cabinetry.

†An electrical supply with grounded three-prong receptacle is required. The power supply circuit must be installed in accordance with current edition of National Electrical Code (NFPA 70) and local codes & ordinances.

NOTE: Always consult local and national electric and plumbing codes. Refer to Product Installation Guide for detailed installation instructions on the web at electroluxappliances.com.

Specifications subject to change.

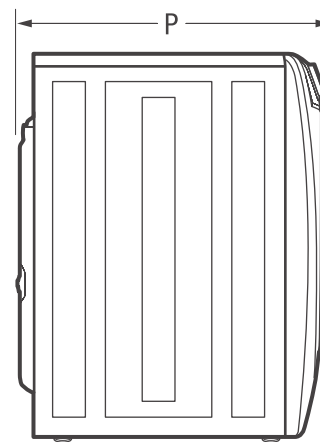
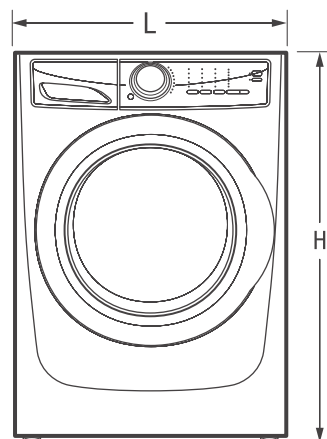

PRODUCT DIMENSIONS

Height (without 15" Pedestal)	38"
(with 15" Pedestal)	53-1/4"
Width	27"
Depth (to Center of Arc Not Including Hose)	32"
(with Door 90° Open)	50-5/8"

Electrolux Major Appliances, N.A.

USA • 10200 David Taylor Drive • Charlotte, NC 28262 • 1-877-4electrolux (1-877-435-3287) • electroluxappliances.com
 CANADA • 5855 Terry Fox Way • Mississauga, ON L5V 3E4 • 1-800-265-8352 • electroluxappliances.ca

EFLS627U 05/18

© 2018 Electrolux Home Products, Inc.



High standards of quality at Electrolux Home Products, Inc. mean we are constantly working to improve our products. We reserve the right to change specifications or discontinue models without notice.

FRONT LOAD WASHER

EFLS627U TT /IW

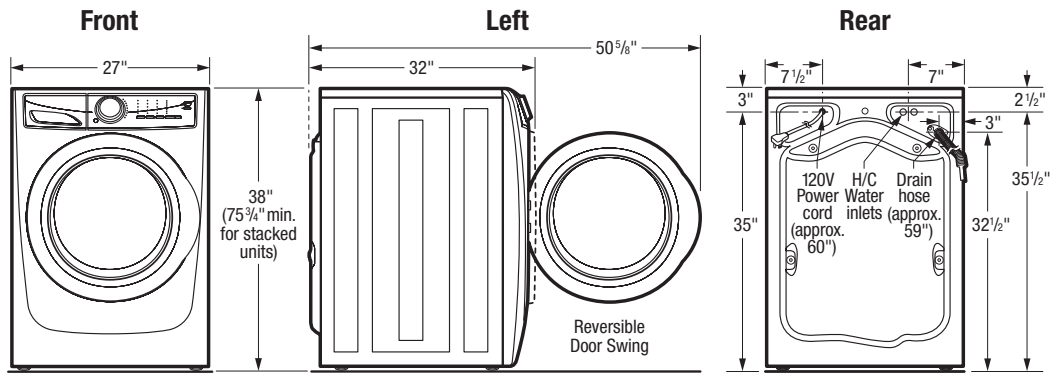

15" Pedestal Drawer Installation

Elevates washer height to 53 1/4". For detailed pedestal installation, refer to instructions included with pedestal or on web. Pedestal installation may require modified utility hookup locations. For details, refer to Product Installation Guide on web.

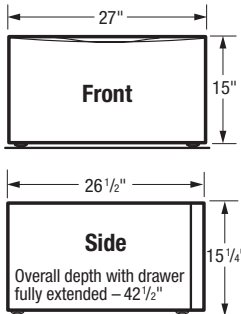

Built-In Installations

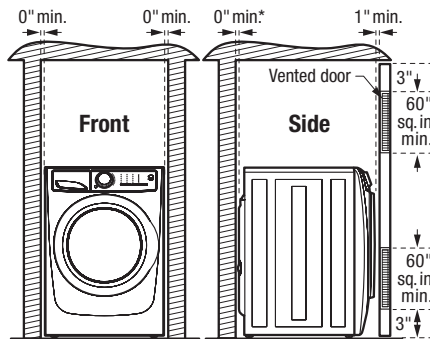

*Installation with steam dryer requires additional 3/4" hose clearance.

Closet Installation:

If washer and dryer are installed in same closet, door(s) MUST be vented with 120 sq. in. minimum louvered opening, equally divided, located 3" from top and bottom of door. Louvered door(s) with equivalent air openings for full-length of door is acceptable. Air openings MUST remain unobstructed with door(s) installed.

Installation Clearances:

Washer can be built in alone or with dryer (side by side or stacked) in closet, recess or under counter installation with 0" minimum clearance required around sides and back of unit(s). To achieve 0" minimum rear clearance when installed with dryer, dryer MUST be vented straight back or with quick-turn 90° elbow. Steam dryer requires additional 3/4" steam hose clearance at back of unit(s). Installation of closet door(s) requires additional 1" minimum clearance between front of unit(s) and door(s). Location of plumbing, exhaust and utility hookups MUST be considered when planning any built-in installation. For additional installation details, refer to Product Installation Guides on web.

Under Counter Installation:

Installation of washer alone or side by side with dryer under counter, requires custom-built countertop and/or cabinetry to accommodate unit(s) height.

Stacking Units:

Stacking dryer above washer requires use of optional Stacking Kit (PN# STACKIT7X) with modified utility hookup locations for dryer. For complete installation details, refer to instructions included with Stacking Kit or on web.

Front Load Washer Specifications

- Product Weight – 237 Lbs. / Shipping Weight – 247 Lbs.
- An electrical supply with grounded three-prong receptacle is required. The power supply circuit must be installed in accordance with current edition of National Electrical Code (ANSI/NFPA 70) and local codes & ordinances. (Do not use same circuit as dryer.)
- Voltage Rating – 120V/60Hz
- Connected Load (kW Rating) @ 120 Volts = 1.2 kW
- Amps @ 120V = 12A
- Equipped with 120V 3-wire power supply cord, approx. 60" long.
- Always consult local and national electric & plumbing codes.
- To maximize detergent effectiveness, ambient temperature should never be below 60°F.
- Can be installed alone, with or without optional 15" pedestal drawer, or stacked beneath matching Electrolux Dryer, which requires installation of optional dryer stacking kit. (For installation details, refer to instructions included with optional pedestal or stacking kit or on web.)
- Can be built in alone or with matching Electrolux Dryer (side by side or stacked) in closet, recess or under counter installation with 0" minimum clearance required around sides and back of unit(s). To achieve 0" minimum rear clearance when installed with dryer, dryer MUST be vented straight back or with quick-turn 90° elbow. Steam dryer requires additional 3/4" steam hose clearance at back of unit(s). Installation of closet door(s) requires additional 1" minimum clearance between front of unit(s) and door(s). Location of plumbing, exhaust and utility hookups MUST be considered when planning any built-in installation.
- Under-counter installation requires custom-built countertop and/or cabinetry to accommodate unit(s) height.

- Do NOT install in area exposed to dripping water or outdoor weather conditions, or where gasoline or other flammables, including automobiles, are kept or stored.
- For garage installation, washer MUST be located minimum 18" above floor.
- Floor MUST be solid with 1" maximum slope. To ensure vibration or movement does not occur, reinforcement of floor may be necessary. Do NOT install on carpeted surface.
- Leveling legs supplied to level washer properly and reduce excessive noise and vibration.
- H/C water faucets MUST be installed within 42" of washer's water inlet and MUST be 3/4" garden hose type, to connect to 48-1/2" inlet hoses.
- Water pressure MUST be between 20 and 120 psi with NOT more than 10 psi pressure difference between hot and cold.
- Drain required with standpipe diameter of 1-1/4" min. and height of 24" min./ 96" max. above floor, capable of eliminating 17 gallons per minute. Attached 59" drain hose can reach 79"-high standpipe.

Note: For planning purposes only. Refer to Product Installation Guide on the web at electroluxappliances.com for detailed instructions.

Optional Accessories

- Pedestal Drawers – Titanium (PN# EPWD257UTT), Island White (PN# EPWD257UIW).
- Dryer Stacking Kit – (PN# STACKIT7X).
- Drain Hose Extension Kit – (PN# 137098000).

Electrolux Major Appliances, N.A.

USA • 10200 David Taylor Drive • Charlotte, NC 28262 • 1-877-4electrolux (1-877-435-3287) • electroluxappliances.com
CANADA • 5855 Terry Fox Way • Mississauga, ON L5V 3E4 • 1-800-265-8352 • electroluxappliances.ca

EFLS627U 05/18

© 2018 Electrolux Home Products, Inc.



High standards of quality at Electrolux Home Products, Inc. mean we are constantly working to improve our products. We reserve the right to change specifications or discontinue models without notice.

ELECTRIC FRONT LOAD DRYER

8.0 Cu. Ft.

EFME527U TT/IW

Perfect Steam™ Dryer with Instant Refresh™ and IQ-Touch™ Controls



SIGNATURE FEATURES



HELP PREVENT OVER- OR UNDER- DRYING WITH LUXCARE® DRY SYSTEM

A more precise sensor for a better dry to protect your clothes from over-drying, but also to help make sure you don't have wet clothes left in the load.



INSTANT REFRESH™ CYCLE REVIVES FABRICS

Remove wrinkles and quickly refresh items with steam in 10 minutes.



18-MINUTE FAST DRY¹

Quickly dry the items you need most.



ENERGY STAR®-CERTIFIED

Rigorously tested to do more with less. Electrolux dryers meet strict criteria to guarantee high-quality energy efficient performance.

PRODUCT DIMENSIONS

Height	38"
Width	27"
Depth	31-1/2"

MORE EASY-TO-USE FEATURES

PERFECT STEAM™ WRINKLE RELEASE OPTION

Gently releases wrinkles and reduces static to keep clothes looking their best.

EXTENDED TUMBLE OPTION KEEPS CLOTHES TANGLE-FREE

Gently tumbles your clothes without heat to keep them tangle-free — perfect for when you cannot remove clothes right after the cycle ends.

LUXCARE® LINT SHIELD HELPS AVOID MESSSES

Traps lint so it doesn't make a mess, even if you empty it while there are clothes in the dryer.

ACTIVWEAR CYCLE

Takes care of delicate and expensive activewear garments.

EXTRA-LARGE CAPACITY DRYER

Dry more in each load with our 8.0 cu.ft. dryers.

PLATINUM STAR® LIMITED WARRANTY

Our exclusive limited warranty that includes three-year coverage on parts and one year on labor.²

8 CYCLES TO CARE FOR EVERY FABRIC

Perfectly dry every item with tailored cycles for towels, delicates, and more.

FITS MORE ROOMS WITH REVERSIBLE DOOR

Enjoy easy loading no matter how your washer and dryer are configured.

OPTIONAL PEDESTALS AND STACKING KIT FOR MORE INSTALLATION OPTIONS

Raise your units with optional pedestal drawers that provide extra storage. Or use the optional stacking kit for convenient placement in small spaces.

LUXURY-DESIGN® LIGHTING

Conveniently find any article of clothing with premium LED lighting that provides visibility inside your dryer.

Available in:



Titanium
(TT)



Island White
(IW)

¹Fastest time based on smallest load/Fast Dry cycle selected for various load compositions.

²Eligibility based on product registration with Electrolux North America within 60 days of purchase. Products must have been purchased on or after July 1, 2013. See limited warranty for details. Limited time offer.

ELECTRIC FRONT LOAD DRYER

EFME527U TT/IW



27" ELECTRIC FRONT LOAD DRYER

Capacity D.O.E.	8.0 Cu.Ft.
-----------------	------------

FEATURES

Pull-to-Open Door	Yes
IQ-Touch™ Controls	Yes
Perfect Steam™ Dry System	Yes
Dry System	LuxCare®
Sound System	Luxury-Quiet™
Lighting	Luxury-Design® LED
Tumble System	Gentle Tumble™
Moisture Sensor	Yes
Dryer Drum	Painted Steel
Tumble Speed (RPM)	50
Reversible Door	Yes
Adjustable Leveling Legs	Yes
ENERGY STAR®	Yes

CYCLES

Timed Dry (30, 45, 60, 75), Heavy Duty/Towels, Normal, 18-Min. Fast Dry, Activewear, Mixed Load, Delicates, Instant Refresh™	8
--	---

OPTIONS

Temperature Selections	5
Add Steam	Yes
Electronic Auto Dry System	Yes
Manual Timed Dry Selections	4
Delay Start (Hours)	12
End-of-Cycle Chime	On/Off
Extended Tumble	Yes
Anti-Static	Yes
Line Dry	Yes
Dryness Levels	5

INSTALLATION OPTIONS

Freestanding, Under Counter*, Stacked (Above Washer), Pedestal, Hidden (In Closet), Second Floor	Yes
4-Way Dryer Venting	Yes

ACCESSORIES

Luxury-Glide® Pedestal with Spacious Storage Drawer—Titanium — PN # EPWD257UTT	Optional
Island White — PN # EPWD257UIW	Optional
Dryer Stacking Kit — PN # STACKIT7X	Optional
Drying Rack — PN # A04840701	Optional
Assembly Hose Kit — PN # 5304495002	Optional

SPECIFICATIONS

Color —	
Titanium	TT
Island White	IW
Maximum Exhaust Duct Length** (Ft.)	125
Power Supply Connection Location	Rear
Voltage Rating	240V/60 Hz/30A
Connected Load (kW Rating) @ 240 Volts	6.0
Amps @ 240 Volts	25
Heating Element @ 240 Volts (Watts)	5,400
Shipping Weight (Approx.)	140 Lbs.

*Side-by-Side units in under-counter installation require custom-built countertop and/or cabinetry.

**Rigid metal duct preferred, semi-rigid optional and allow deductions for elbows and vents. Refer to Installation Guide on web for additional information.

NOTE: Always consult local and national electric and plumbing codes. Refer to Product Installation Guide for detailed installation instructions on the web at electroluxappliances.ca.

Specifications subject to change.

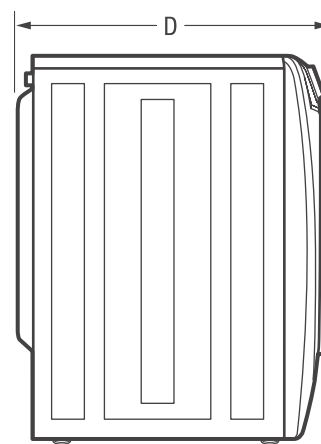
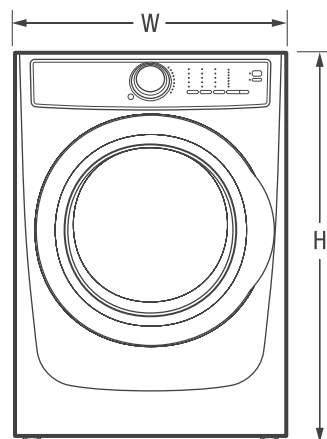

PRODUCT DIMENSIONS

Height (without 15" Pedestal)	38"
(with 15" Pedestal)	53-1/4"
Width	27"
Depth (to Center of Arc Not Including Hose)	31-1/2"
(with Door 90° Open)	50-5/8"

Electrolux Major Appliances, N.A.

USA • 10200 David Taylor Drive • Charlotte, NC 28262 • 1-877-4electrolux (1-877-435-3287) • electroluxappliances.com
 CANADA • 5855 Terry Fox Way • Mississauga, ON L5V 3E4 • 1-800-265-8352 • electroluxappliances.ca

EFME527U 0518

© 2018 Electrolux Home Products, Inc.



High standards of quality at Electrolux Home Products, Inc. mean we are constantly working to improve our products. We reserve the right to change specifications or discontinue models without notice.

ELECTRIC FRONT LOAD DRYER

EFME527U TT/IW

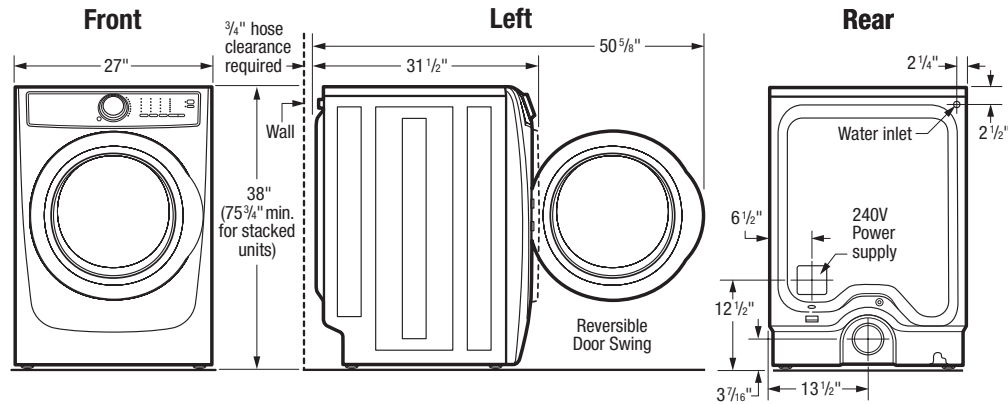

15" Pedestal Drawer Installation

Elevates dryer height to 53 1/4". For detailed pedestal installation, refer to instructions included with pedestal or on web. Pedestal installation may require modified utility hookup locations. For details, refer to Product Installation Guide on web.

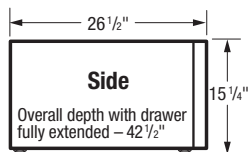
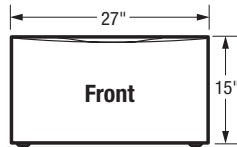

Built-In Installations

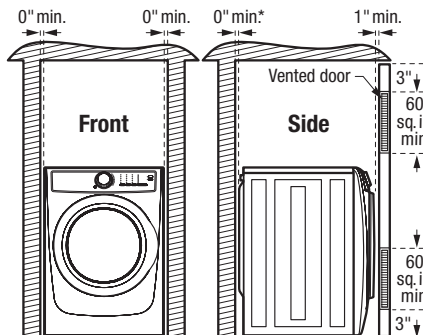

*Steam dryer requires additional 3/4" hose clearance.

Closet Installation:

If washer and dryer are installed in same closet, door(s) MUST be vented with 120 sq. in. minimum louvered opening, equally divided, located 3" from top and bottom of door. Louvered door(s) with equivalent air openings for full-length of door is acceptable. Air openings MUST remain unobstructed with door(s) installed.

Installation Clearances:

Dryer can be built in alone or with washer (side by side or stacked) in closet, recess or under counter installation with 0" minimum clearance required around sides and back of unit(s). To achieve 0" minimum rear clearance, dryer MUST be vented straight back or with quick-turn 90° elbow. Steam dryer requires additional 3/4" steam hose clearance at back of unit(s). Installation of closet door(s) requires additional 1" minimum clearance between front of unit(s) and door(s). Location of plumbing, exhaust and utility hookups MUST be considered when planning any built-in installation. For additional installation details, refer to Product Installation Guides on web.

Under Counter Installation:

Installation of dryer alone or side by side with washer under counter, requires custom-built countertop and/or cabinetry to accommodate unit(s) height.

Stacking Units:

Stacking dryer above washer requires use of optional Stacking Kit (PN# STACKIT7X) with modified utility hookup locations for dryer. For complete installation details, refer to instructions included with Stacking Kit or on web.

Electric Dryer Specifications

- Product Weight – 130 Lbs. / Shipping Weight – 140 Lbs.
- Voltage Rating – 240/60 Hz/30A
- Single phase 3- or 4-wire cable, 240 Volt, 60 Hertz AC only electrical supply with ground required on separate circuit fused on both sides of line. (Do not use same circuit as washer.)
- Connected Load (kW Rating) @ 240 Volts = 6.0 kW
- Amps @ 240V = 25A
- Dryer MUST employ a 3-conductor NEMA 10-30 type SRDT or 4-conductor NEMA 14-30 type SRDT or ST (as required), rated at 240 volt AC minimum, 30 amp power supply cord marked for use with clothes dryers (not supplied).
- Grounding through neutral link prohibited in specific applications and certain locales, requiring use of 4-wire system. (For detailed electrical requirements, refer to Product Installation Guide on web.)
- Always consult local and national electric & plumbing codes.
- Can be installed alone, with or without optional 15" pedestal drawer, or stacked above matching Electrolux Washer, which requires installation of optional dryer stacking kit. (For installation details, refer to instructions included with optional pedestal or stacking kit or on web.)
- Can be built in alone or with matching Electrolux Washer (side by side or stacked) in closet, recess or under counter installation with 0" minimum clearance required around sides and back of unit(s). To achieve 0" minimum rear clearance, dryer MUST be vented straight back or with quick-turn 90° elbow. Steam dryer requires additional 3/4" steam hose clearance at back of unit(s). Installation of closet door(s) requires additional 1" minimum clearance between front of unit(s) and door(s). Location of plumbing, exhaust and utility hookups MUST be considered when planning any built-in installation.
- Under-counter installation requires custom-built countertop and/or cabinetry to accommodate unit(s) height.

- Do NOT install in area exposed to dripping water or outdoor weather conditions, or where gasoline or other flammables, including automobiles, are kept or stored.
- For garage installation, dryer MUST be located minimum 18" above floor.
- Floor MUST be solid with 1" maximum slope. To ensure vibration or movement does not occur, reinforcement of floor may be necessary. Do NOT install on carpeted surface.
- Dryer MUST exhaust to outside of building, NOT into any concealed space.
- Dryer equipped for 4-way venting and approved for up to 125-foot-equivalent of duct length, determined by length of run and number of elbows needed.
- Exhaust installation requires minimum 4"-diameter rigid or semi-rigid metal duct with approved, unobstructed vent hood having swing-out damper(s). If installing rigid metal duct (preferred), do not exceed MAXIMUM venting run length of 125 ft., allow deductions for elbows and vents. If installing semi-rigid metal duct, do not exceed MAXIMUM venting run length of 8 ft., always allow deductions for elbows and vents (Refer to Product Installation Guide on web for additional information). Do NOT use flexible plastic or metal foil duct and use shortest run possible.
- Leveling legs supplied to level dryer properly and reduce excessive noise and vibration.
- Water inlet hose for steam setting connects to cold water supply with "Y" connector and requires 3/4" clearance between back of unit and wall.

Note: For planning purposes only. Refer to Product Installation Guide on the web at electroluxappliances.com for detailed instructions.

Optional Accessories

- Pedestal Drawers – Titanium (PN# EPWD257UTT), Island White (PN# EPWD257UIW).
- Dryer Stacking Kit – (PN# STACKIT7X).
- Drying Rack – (PN# A04840701).
- Assembly Hose Kit – (PN# 5304495002).

Electrolux Major Appliances, N.A.

USA • 10200 David Taylor Drive • Charlotte, NC 28262 • 1-877-4electrolux (1-877-435-3287) • electroluxappliances.com
CANADA • 5855 Terry Fox Way • Mississauga, ON L5V 3E4 • 1-800-265-8352 • electroluxappliances.ca

EFME527U 0518

© 2018 Electrolux Home Products, Inc.



High standards of quality at Electrolux Home Products, Inc. mean we are constantly working to improve our products. We reserve the right to change specifications or discontinue models without notice.

BI-48S/O



FEATURES

Monitor and control remotely with Wi-Fi connectivity

Accepts custom panels for an integrated look within cabinetry or stainless-steel accessory panels and handles to match other Sub-Zero, Wolf, and Cove products

Preserves refrigerated foods with cool, moist air and frozen foods with frigid, dry air

Fight spoilage and odors with a NASA-inspired air purification system

Locks in cold air to ensure freshness with magnetic door seals

Keeps produce fresher with high-humidity, sealed crisper and deli drawers

Controls temperature within one degree of setpoint

Filters water and ice, removing contaminants, chlorine taste, and odor

Yields ice automatically and "max ice" for additional production

Ensures excellent visibility with bright halogen lights

Refer to freshness cards for tips on food preservation, use, and care

ACCESSORIES

48" Stainless Steel Kickplate

90° Door Stop

Air Purification Cartridge

Custom Front Panel Mounting Kit

Custom Side Panel Mounting Kit

Egg Container

Extended Framed Handle Kit

Framed Handle Kit

Framed Louvered Grille Insert

Framed Stainless Steel Front Panels

Framed White Front Panels

Pro Louvered Flush Inset Grille - 84"

Stainless Steel Flush Inset Freezer Door Panel with Pro Handle

Stainless Steel Flush Inset Freezer Door Panel with Tubular Handle

Stainless Steel Flush Inset Grille Panel

Stainless Steel Flush Inset Refrigerator Door Panel with Pro Handle

Stainless Steel Flush Inset Refrigerator Door Panel with Tubular Handle

Stainless Steel Side Panel

Water Filter

Water Filter By-Pass Plug

White Side Panel

Stainless Steel Pro Handles

Stainless Steel Tubular Handles



HANDLE ACCESSORIES

PRO



TUBULAR



PRODUCT DETAILS

REFRIGERATOR

- 1 adjustable dairy compartment
- 1 high-humidity crisper drawer with adjustable dividers
- 2 refrigerator storage drawers with adjustable dividers
- 5 glass refrigerator shelves (4 adjustable; 1 stationary)
- 5 refrigerator door bins (3 adjustable; 2 stationary)
- LED refrigerator and freezer lights

FREEZER

- 5 adjustable freezer door bins
- 4 wire freezer shelves (3 adjustable; 1 stationary)
- 3 freezer storage drawers

Built-In Louvered Grilles

Built-In Overlay or Flush Inset Grille Frames

Accessories are available through an authorized dealer.
For local dealer information, visit subzero-wolf.com/locator.

Specifications are subject to change without notice. This information was generated on July 5, 2019. Verify specifications prior to finalizing your cabinetry/enclosures.

PRODUCT SPECIFICATIONS

Model	BI-48S/O
Dimensions	48"W x 84"H x 24"D
Door Clearance	30"
Weight	630 lbs
Refrigerator Capacity	19.1 cu. ft.
Freezer Capacity	9.8 cu. ft.
Electrical Supply	115 VAC, 60 Hz
Electrical Service	15 amp dedicated circuit
Receptacle	3-prong grounding-type

ELECTRICAL

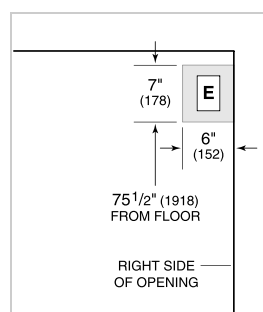

PLUMBING

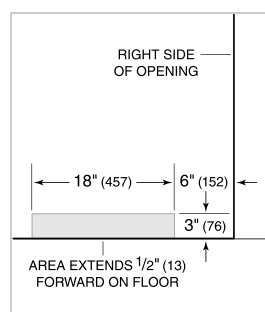

PANEL SPECIFICATIONS For complete panels specifications including width/height, weight requirements, thickness requirements and offset details visit subzero-wolf.com/builtinconfigurator.

NOTE: Dimensions in parenthesis are in millimeters unless otherwise specified

INTERIOR VIEW



This illustration is intended for interior reference only and may not represent the exterior of the model being specified.

DIMENSIONS

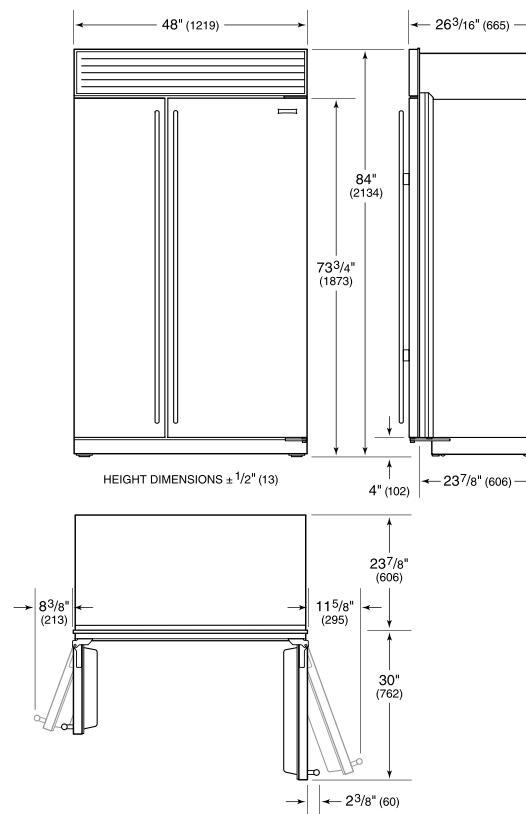

FLUSH INSET INSTALLATION

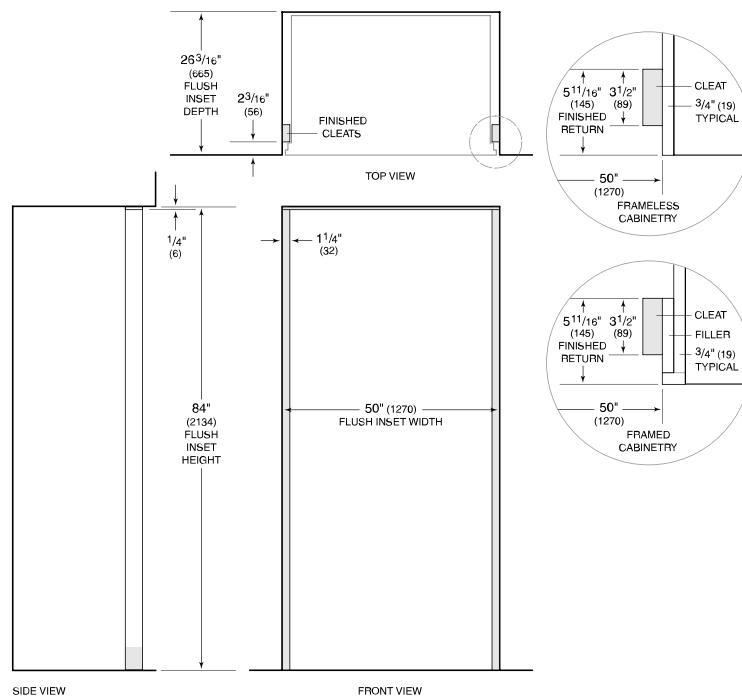

NOTE: 3/16" (89) finished returns and shaded areas will be visible and should be finished to match cabinetry. Shaded line represents profile of unit with 3/4" (19) panel.

DF486G



FEATURES

Cook at higher highs and lower lows with six dual-stacked, sealed burners that produce up to 20,000 Btu and deliver as low as 300 Btu

Rely on a 7,500 Btu infrared double griddle to sear burgers, stir-fry vegetables, and more

Clean up sloshes and spills easily with the seamless, sealed, black porcelain-coated burner pans

Assures predictably delicious results with a variety of modes including Convection Roast, Proof, and Dehydrate

Control heat and airflow expertly as dual convection creates just the right cooking environment for everything from Cornish hens to cherry pie to butternut squash

Operate easily with a control panel that rotates out of sight when not in use

Leave nothing to chance. Our temperature probe alerts you when your dish has reached the desired temperature for worry-free, delicious results

Includes options such as self-clean, delayed start, timed cook, Sabbath mode, and more

Re-ignites flame automatically with our spark ignition system for improved temperature control and added safety

Move pots and pans around easily with continuous cast-iron grates

Find your kitchen style with a choice of iconic red, black, or brushed stainless control knobs

See food clearly with bright interior halogen lights and large double-panel glass door windows

ACCESSORIES

11" Cutting Board

18" Broiler Pan

18" Dehydration Kit

18" Full-Extension Oven Rack

18" Standard Oven Racks

2-Burner Wok Grate

3 1/4" (83) Front Leg Covers

3 1/4" (83) Rear Caster Covers

3 3/4" (95) Front Leg Covers

3 3/4" (95) Rear Caster Covers

30" Bake Stone Kit

30" Broiler Pan

30" Full-Extension Oven Rack

4 1/4" (108) Front Leg Covers

4 1/4" (108) Rear Caster Covers

4 3/4" (121) Front Leg Covers

4 3/4" (121) Rear Caster Covers



KNOB OPTIONS



TOP CONFIGURATION

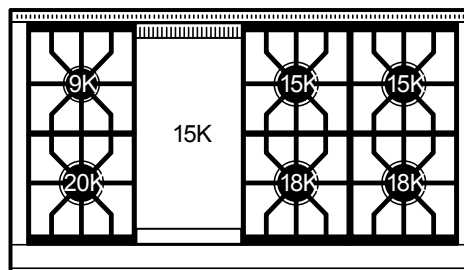

RANGETOP SPECIFICATIONS

- 1 - 9,200 Btu burner
- 2 - 15,000 Btu burners
- 2 - 18,000 Btu burners
- 1 - 15,000 Btu (14,000 Btu LP) griddle
- Stainless-steel griddle cover

48" Stainless Steel Kickplate
48" and 60" Black Knobs
48" and 60" Red Knobs
48" and 60" Stainless Steel Knobs
Dehydration Kit
Filler Trim
Griddle Ceaning Pads
Griddle Cleaning Kit
Griddle Cleaning Solution
Oven Rack Set (3)
Premier Baking Sheet
S-Grates
Temperature Probe
Stainless steel, brass or chrome bezels
5" and 10" stainless steel risers, and 20" riser with shelf
Accessories available through an authorized dealer. For local dealer information, visit subzero-wolf.com/locator .

Specifications are subject to change without notice. This information was generated on July 5, 2019. Verify specifications prior to finalizing your cabinetry/enclosures.

DIMENSIONS

Technical drawing of the Wolf 48-inch dual-fuel range, showing front and side views with dimensions in inches and millimeters.

Front View Dimensions:

- Overall Width: 47 7/8" (1216)
- Overall Height: 36 7/8" (937)*
- Top Control Panel Height: 3 6 7/8" (937)*
- Lower Oven Door Height: 35 7/8" (911)

Side View Dimensions:

- Overall Depth: 24 1/8" (613)
- Upper Cabinet Clearance: 29 1/2" (749)
- Lower Cabinet Clearance: 27 1/2" (699)
- Upper Cabinet Clearance (with handle): 55 7/8" (1419)
- Lower Cabinet Clearance (with handle): 45 7/8" (1165)
- Lower Cabinet Clearance (with handle): 40 7/8" (1038)
- Upper Cabinet Clearance (with handle): 9 1/4" (235)
- Upper Cabinet Clearance (with handle): 25" (635)
- Upper Cabinet Clearance (with handle): 26 1/8" (664)
- Overall Depth (with handle): 36 7/8" (937)*
- Overall Depth (with handle): 47" (1194)

Notes:

- *36 7/8" (937) MIN TO 39" (991) MAX.

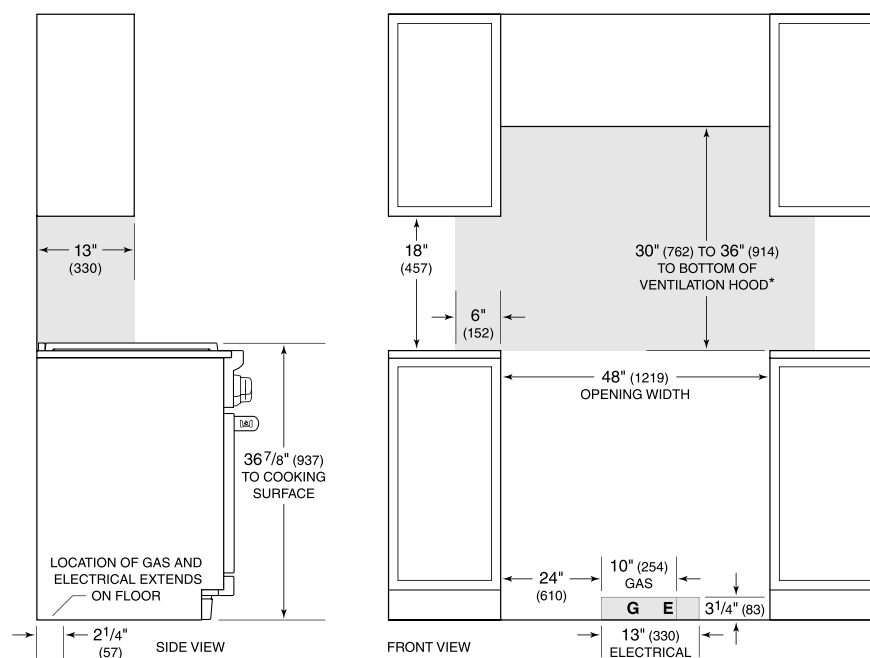
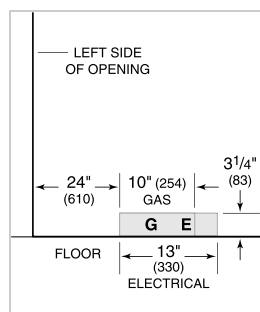

For island installation, 12" (305) minimum clearance back of range to combustible rear wall above countertop.

DW2450



FEATURES

Available April 2019

Adapts easily to differently shaped dishes and glasses with a height-adjustable middle rack and fold-down tines

Removes food and grease with three powerful spray arms and custom wash and dry options for different soil levels

Filters food efficiently through fine mesh for cleaner water throughout every cycle

Dries every type of dish, utensil, and pan thoroughly with a hot rinse and fan-assist

Operates in near silence that never interrupts

Matches classic Wolf and Sub-Zero stainless steel or accepts custom panels to integrate into any kitchen design

Provides better visibility with interior LED lights

Maintains clean lines with hidden control panel and floor status light

Marvel at the timeless look of sleek stainless steel inside and out for decades of use

Monitor cycle progress, even start a new cycle, remotely. Receive alerts when rinse aid is low.

ACCESSORIES

Pro Handle

Tubular Handle

24" Stainless Steel Door Panels

60cm Stainless Steel Door Panels

24" Stainless Steel Kickplates

60cm Stainless Steel Kickplates

Accessories are available through an authorized dealer.
For local dealer information, visit subzero-wolf.com/locator.



HANDLE ACCESSORIES

PRO



TUBULAR



PRODUCT DETAILS

DISHWASHER

- 4 LED lights (2 sides; 2 top)
- 43 spray jets across three spray arms
- Four-stage, fine mesh filter
- Adjustable stemware rail
- Adjustable cup shelf
- Height-adjustable middle rack
- Easy-glide bottom rack
- Removable top utensil rack
- One large utensil basket

PRODUCT SPECIFICATIONS

Model	DW2450
Dimensions	23 5/8"W x 34 1/2"H x 23 1/4"D
Door Clearance	26 3/4"
Electrical Supply	115 VAC, 60 Hz
Electrical Service	15 amp dedicated circuit
Receptacle	3-prong grounding-type
Cord Length	3'
Water Connection	5' braided tubing with 3/8" female compression fitting
Drain Connection	5' (1.5 m) corrugated tubing
Plumbing Pressure	30–140 psi

ELECTRICAL

PLUMBING

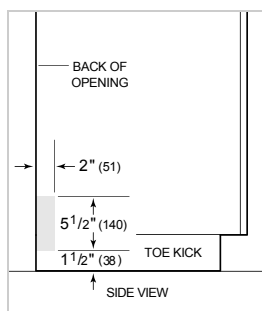
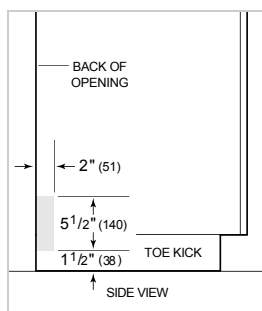

NOTE: Dimensions in parenthesis are in millimeters unless otherwise specified

PANEL SPECIFICATIONS For complete panels specifications including width/height, weight requirements and thickness requirements visit subzero-wolf.com/reveal.

INTERIOR VIEW

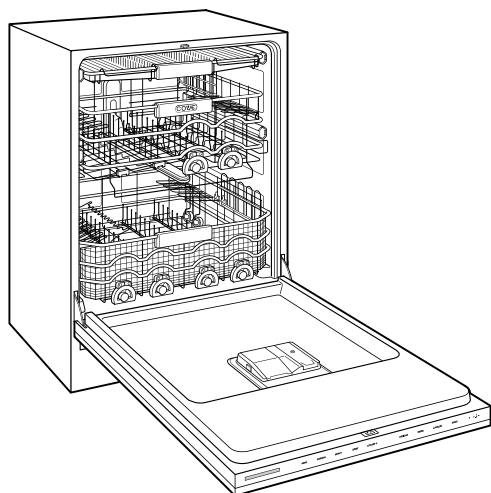

This illustration is intended for interior reference only and may not represent the exterior of the model being specified.

DIMENSIONS

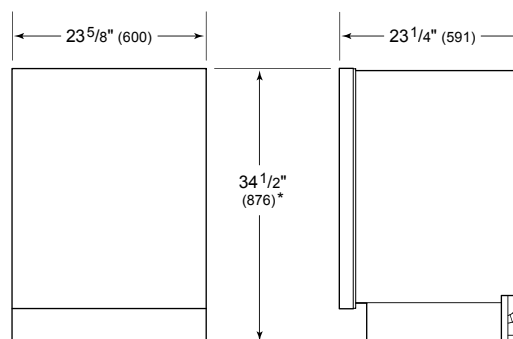

*34" (864) MIN TO 34 5/8" (880) MAX

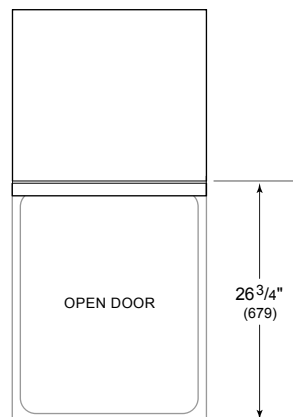

MDD30PM/S/PH**FEATURES**

Distributes heat evenly with no hot or cold spots allowing for oven-like operation

Installs standard or flush to conceal the oven from view

Matches M series ovens, coffee systems, convection steam oven

Utilizes 900 watts of power to cook meals with delicious results

Select from 10 power levels, a warming mode, and sensor cooking

Rely on quick-start controls for tasks like melting, softening, defrosting, and popcorn

Let the microwave do the cooking with intuitive "gourmet mode" settings

Install into surrounding cabinetry to coordinate with other Wolf built-in ovens and warming drawers

ACCESSORIES

Side Trim

Accessories available through an authorized dealer.

For local dealer information, visit subzero-wolf.com/locator.





PRODUCT SPECIFICATIONS

Model	MDD30PM/S/PH
Dimensions	29 7/8"W x 17 7/8"H x 20"D
Capacity	1.6 cu. ft.
Door Clearance	14 3/16"
Electrical Supply	120 VAC, 60 Hz
Electrical Service	15 amp dedicated circuit
Power Cord Length	4 Feet
Receptacle	3-prong grounding-type

ELECTRICAL

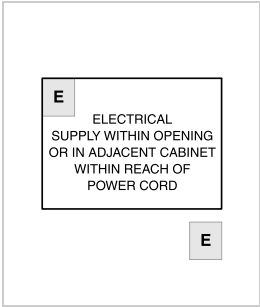

NOTE: Dimensions in parenthesis are in millimeters unless otherwise specified

DIMENSIONS

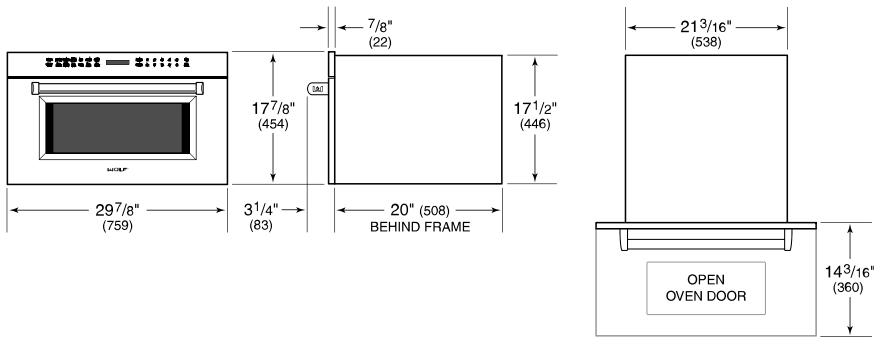

FLUSH INSTALLATION

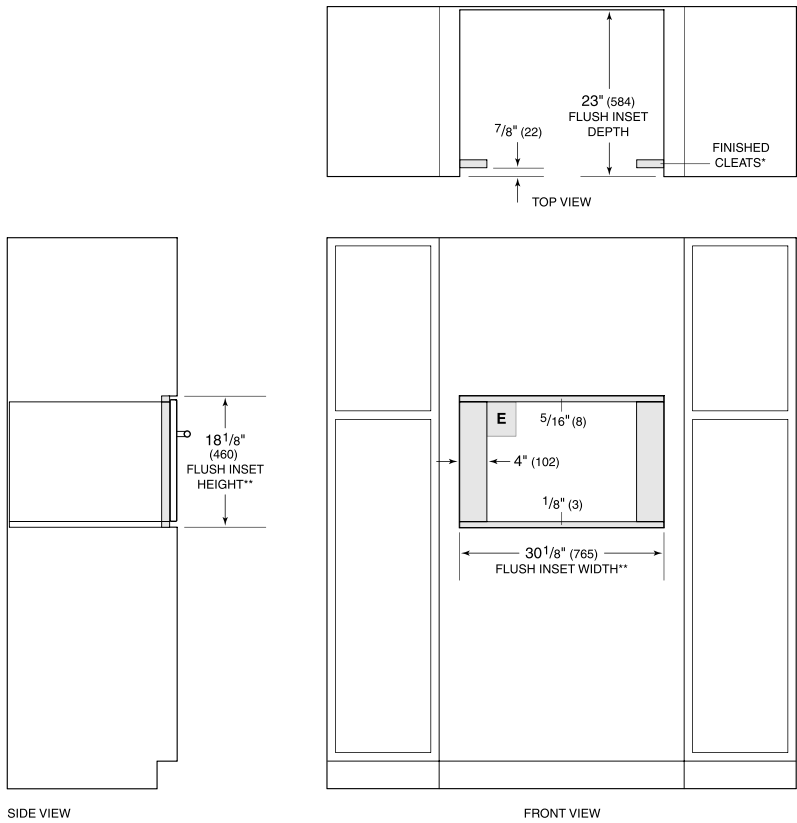

*Will be visible and should be finished to match cabinetry.
**Dimension provides minimum reveals.

2698 Cortina Residence – Plumbing Fixtures

BERGLUND Architects, LLC

TRANSITIONAL EXTENDED REACH PLP PULLDOWN FAUCET

5700



Finish Shown - Stainless Steel

FEATURES

- "Positive Lock Pulldown" design locks sprayer in place when not in use.
- Spout has 11-1/8" extended reach for larger sinks and can swivel 360 degrees.
- Lever handle spray head pulls out 18" from spout.
- Counterbalanced weight on spray hose allows smooth pull out and prevents snap back.
- Sprayer instantly diverts water from aerated stream to wide spray when handle is held.
- 1.75 gpm maximum flow rate with aerated tip.
- Adjustable handle tension ring helps handle feel and prevents sag.
- Single handle can mount in front, right or left hand positions.
- When mounted on side, handle can adjust 22.5 degrees for backsplash clearance.
- Hot/cold ceramic disk valve cartridge.
- Resistant to reverse osmosis water.
- Made from solid brass or 316 stainless steel.
- Reinforced braided connection hoses.
- Includes reversible or removable hot/cold indicator ring.
- Lifetime functional warranty.
- Made in the USA.

CODES/STANDARDS APPLICABLE

Specified model meets or exceeds the following:

- **ASME A112.18.1**
- **CSA B125.1**
- **NSF 61, 372**
- **CALGreen**



AVAILABLE IN 30 FINISHES + SOLID 316 MARINE GRADE STAINLESS STEEL

TRANSITIONAL EXTENDED REACH PLP PULLDOWN FAUCET

5700

- Max Counter Thickness 2-3/8"
- Minimum Install Hole Size 1-1/2"

- A. Spray Connection with
3/8" Compression Fitting
- B. Supply Hoses - 20" Long with
3/8" Compression Fittings

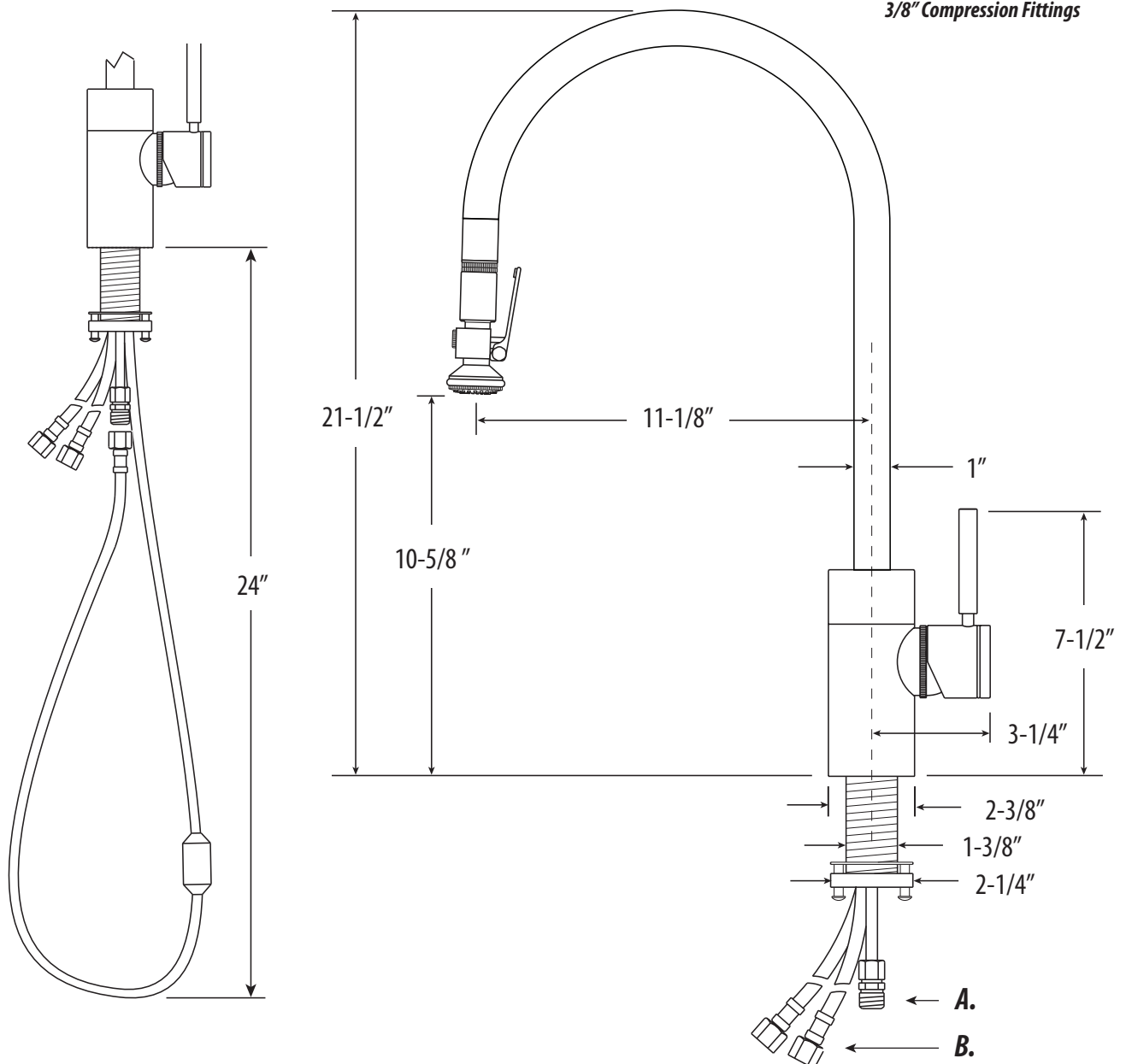

ECO BRASS®
HIGH PERFORMANCE LEAD FREE BRASS

DIMENSIONS MAY VARY AND ARE SUBJECT TO CHANGE. NO RESPONSIBILITY IS ASSUMED FOR USE OF SUPERCEDED OR VOIDED DATA

005453 | SMARTSTATION

UNDERMOUNT STAINLESS STEEL KITCHEN SINK

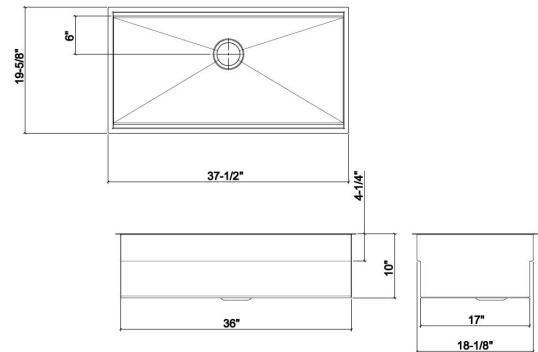

Specifications

Model	005453
Collection	SmartStation
Bowl dimensions	36" x 18 1/8" x 10"
Overall dimensions	37 1/2" x 19 5/8" x 10"
Recommended cabinet	42"

Recommended accessories

Drain	100082
Grid (included)	
Colander	205218
Tray	205221
Tray	205222
Colander (included)	205225
Cutting board (included)	210067
Drying Rack (included)	215207

Warranty

Home Refinements offers a LIMITED LIFETIME WARRANTY on the fixed components of its stainless steel sinks against defects of material and workmanship as well as a 1-YEAR LIMITED WARRANTY following the purchase date for all accessories against defects of material and workmanship. This warranty is limited to defects or damages resulting from a normal residential use. For further details on our product warranty, please refer to our catalog or Web site.

Features

- Handcrafted in Canada
- Commercial quality stainless steel - 16 ga thickness
- Corrosion resistant material - 304 series (18/10)
- Unique design allowing the Home Refinements standard accessories to slide one over the other on two levels
- Accessory ledge on front and back of the bowl to accommodate any standard 17" Home Refinements accessory
- Standard 18" Home Refinements accessories to be used directly on the countertop (undermount with overhang countertop installation necessary)
- Three (3) accessories included, with a choice of maple or walnut handles: 17" drying rack to be used on accessory ledge and 18" colander and cutting board to be used on countertop
- Bottom grid included to protect the surface of the sink
- Attractive combination of UrbanEdge® and J7® collections : vertical square corners [0°] and slightly rounded corners [7mm] for bottom front and back folds
- Environmentally friendly product, 100% recyclable
- Elegant no. 4 brushed finish that matches the appliances
- Highly efficient sound deadening pads
- Practical flat sink bottom and straight bowl sides that maximize available space in the bowl
- Stylish and functional bowl bottom grooves that facilitate water drainage
- Rear or side 3-1/2" drain placement
- Mounting hardware included
- Certifications: ASME A112.19.3, CSA B45.0, CSA B45.4



SS SERIES FOOD WASTE DISPOSERS

Food waste disposers are a hygienic and environmentally sustainable way to manage pre- and post-consumer scraps in a foodservice establishment. The SS Series disposers are ideal for heavy-duty applications such as restaurants, schools and universities, healthcare facilities and hospitals, and government facilities.

PRODUCT FEATURES & SPECIFICATIONS

SS-SERIES

- Whether you serve 25 or 2,500 people, there is an InSinkErator disposer that's designed for your operation. From the small-capacity SS-100™ model to our large-capacity SS-1000™ workhorse, InSinkErator disposers deliver superior performance, quiet operation, maximum energy efficiency, and reliable service.

SYSTEM OVERVIEW

- Stainless steel and chrome-plated finish
- Corrosion-resistant, stainless steel grind chamber
- Heavy-duty induction motor with built-in thermal overload protection
- Enclosure provides protection against outside moisture with controlled power air flow to cool motor
- Cast-nickel, chrome-alloy stationary and rotating shredding elements
- Double-tapered Timken roller bearings provide a shock-absorbing cushion
- Triple lip seal protects motor from water damage
- Secondary spring-loaded oil seal provides double protection against water and loss of grease

CLEANING

- Disposers are easy to clean and maintain
- Wipe down exterior surfaces with a wet cloth
- Use warm soapy water on the splashguard



1
YEAR

ON-SITE
PARTS & LABOR
WARRANTY

Commercial Disposer Sizing Chart

To determine the proper size disposer, use this recommended sizing chart. Sizing recommendations are given in general terms; actual capacities vary depending on the volume and type of food waste.

Volume Processed / Application		High				
		Buffet/Cafeteria				
		Government				
		SS-300	SS-300/ SS-500	SS-500	SS-500/ SS-1000	SS-500/ SS-1000
		SS-200	SS-300	SS-300/ SS-500	SS-500	SS-500/ SS-1000
		SS-100	SS-200	SS-300	SS-300/ SS-500	SS-1000
		SS-100	SS-100	SS-200	SS-300	SS-300/ SS-500
		Light	Medium		Heavy	
		Majority Fruits & Vegetables	50/50 Mixture		Majority Meats & Seafood	
Food Waste Composition						

A complete collection of our product drawings is available for download at the **InSinkErator Revit/CAD Library**, which can be found at www.insinkerator.com/foodservice. Product information is also accessible on **The KCL CADalog**. More information is available from KCL at www.kclcad.com.



4700 21st STREET
RACINE, WI 53406
TEL: 800-845-8345
FAX: 262 554-3620

www.insinkerator.com/foodservice





The Emerson logo is a trademark and a service mark of Emerson Electric Co.







WHAT'S INCLUDED

- Base disposer: 1 mounting gasket
- Disposer packages: 1 mounting/bowl assembly, 1 electrical control, 1 syphon breaker, 1 solenoid valve, and 1 flow control valve (the standard flow control valve will be sent with the unit unless the optional valve is specified)

MODEL & HORSEPOWER/ELECTRICAL REQUIREMENTS (CHOOSE ONE)

Small Capacity Disposers		
	<input type="checkbox"/> SS-100 1 HP	<input type="checkbox"/> 115/208-230V, 60 Hz, 1 Ph, 11.6/5.1/5.7 amps, cULus <input type="checkbox"/> 208-230/460V, 60 Hz, 3 Ph, 2.0/2.4/1.2 amps, cULus <input type="checkbox"/> 120/208-240V, 60 Hz, 1 Ph, 11.6/5.1/5.7 amps, NOM <input type="checkbox"/> 100/200-230V, 50/60 Hz, 1 Ph, 10.4/5.2/5.4 amps
	Water Usage:	<input type="checkbox"/> 5 GPM (18.9 LPM) standard water flow <input type="checkbox"/> 3 GPM (11.4 LPM) reduced water flow (optional)
Medium Capacity Disposer		
	<input type="checkbox"/> SS-200 2 HP	<input type="checkbox"/> 115/208-230V, 60 Hz, 1 Ph, 17.4/7.7/8.7 amps, cULus <input type="checkbox"/> 208-230/460V, 60 Hz, 3 Ph, 3.6/4.4/2.2 amps, cULus <input type="checkbox"/> 115/208-230V, 60 Hz, 1 Ph, 17.4/7.7/8.7 amps, cULus, short body <input type="checkbox"/> 208-230/460V, 60 Hz, 3 Ph, 3.6/4.4/2.2 amps, cULus, short body <input type="checkbox"/> 208-240/460V, 60 Hz, 3 Ph, 3.6/4.4/2.2 amps, NOM
	Water Usage:	<input type="checkbox"/> 7 GPM (26.5 LPM) standard water flow <input type="checkbox"/> 5 GPM (18.9 LPM) reduced water flow (optional)
Large Capacity Disposers		
	<input type="checkbox"/> SS-300 3 HP	<input type="checkbox"/> 208-230/460V, 60 Hz, 3 Ph, 6.0/7.4/3.7 amps, CUL <input type="checkbox"/> 208-230/460V, 60 Hz, 3 Ph, 6.0/7.4/3.7 amps, CUL, short body <input type="checkbox"/> 208-230/460V, 60 Hz, 3 Ph, 7.0/8.6/3.7 amps, NOM <input type="checkbox"/> 415V, 50 Hz, 3 Ph, 4.9 amps <input type="checkbox"/> 220V, 50 Hz, 3 Ph, 7.2 amps <input type="checkbox"/> 380V, 50/60 Hz, 3 Ph, 4.1/3.0 amps
	Water Usage:	<input type="checkbox"/> 8 GPM (30.3 LPM) standard water flow <input type="checkbox"/> 7 GPM (26.5 LPM) reduced water flow (optional)
	<input type="checkbox"/> SS-500 5 HP	<input type="checkbox"/> 208-230/460V, 60 Hz, 3 Ph, 8.6/8.8/4.4 amps, CUL <input type="checkbox"/> 208-230/460V, 60 Hz, 3 Ph, 8.6/8.8/4.4 amps, CUL, short body <input type="checkbox"/> 230/460V, 50 Hz, 3 Ph, 9.0/4.5 amps <input type="checkbox"/> 415V, 50 Hz, 3 Ph, 6.0 amps <input type="checkbox"/> 380V, 50 Hz, 3 Ph, 8.9 amps
	Water Usage:	<input type="checkbox"/> 8 GPM (30.3 LPM) standard water flow <input type="checkbox"/> 7 GPM (26.5 LPM) reduced water flow (optional)
	<input type="checkbox"/> SS-1000 10 HP	<input type="checkbox"/> 208-230/460V, 60 Hz, 3 Ph, 11.0/13.0/6.5 amps, CUL <input type="checkbox"/> 208-230/460V, 60 Hz, 3 Ph, 11.0/13.0/6.5 amps, CUL, short body
	Water Usage:	<input type="checkbox"/> 10 GPM (37.9 LPM) standard water flow

DISPOSER MOUNTING ASSEMBLIES (CHOOSE ONE)

Sink Collar Mounts		Sink Bowl Mounts	
	<input type="checkbox"/> #5 Sink Flange Kit for 3-1/2"–4" (88.9 mm–101.6 mm) sink opening (support legs are recommended) <i>#5 adaptors only available on small and medium capacity disposers.</i>	Bowl Size	Kit Type
		<input type="checkbox"/> 12" (304.8 mm) with one adjustable water nozzle	 <input type="checkbox"/> Type A Sink Bowl Assembly <ul style="list-style-type: none">• bowl• water nozzle(s)• bowl cover• splash baffle
	<input type="checkbox"/> #6 Collar Adaptor Kit for welding into trough, for 6-5/8" (168.3 mm) opening, includes splash baffle	<input type="checkbox"/> 15" (381.0 mm) with one adjustable water nozzle	 <input type="checkbox"/> Type B Sink Bowl Assembly <ul style="list-style-type: none">• bowl• water nozzle(s)• silver guard• splash baffle
	<input type="checkbox"/> #7 Collar Adaptor Kit for welding into sink, for 6-5/8" (168.3 mm) opening, includes splash baffle and stopper	<input type="checkbox"/> 18" (457.2 mm) with two adjustable water nozzles	 <input type="checkbox"/> Type C Sink Bowl Assembly <ul style="list-style-type: none">• bowl• water nozzle(s)• splash baffle

IH75-US-181810

Prolinox H75

Stainless steel kitchen sink

Handcrafted

Contemporary style corners [0,75"]

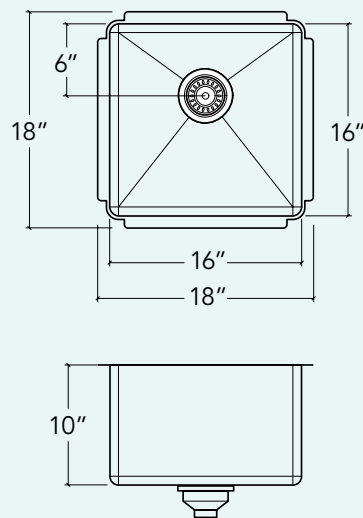

Installation

Undermount

Bowl

16" × 16" × 10"

Overall

18" × 18" × 10"

Recommended cabinet

21"

Drain

Ø 3 ½"

Packaging

19" × 21 ½" × 13"

20 lbs

Features

- 304 brushed finish stainless steel (18/10) – 18 gauge
- Sound deadening pads for maximum noise reduction
- Drain located towards rear providing more space under the sink
- Stainless steel strainer (AA-SA-3.5-SA) and mounting hardware included
- Product certified ASME A112.19.3, CSA B45.0, and CSA B45.4

Must-have accessories



Grid
IH-G-1616



Colander
IH-CA-16



Wood cutting board
IH-BA-16-MA



Plastic cutting board
IH-BB-16-WH

ProInox H75

Undermount installation

A. Countertop made of granite, quartz, marble or other stone surface

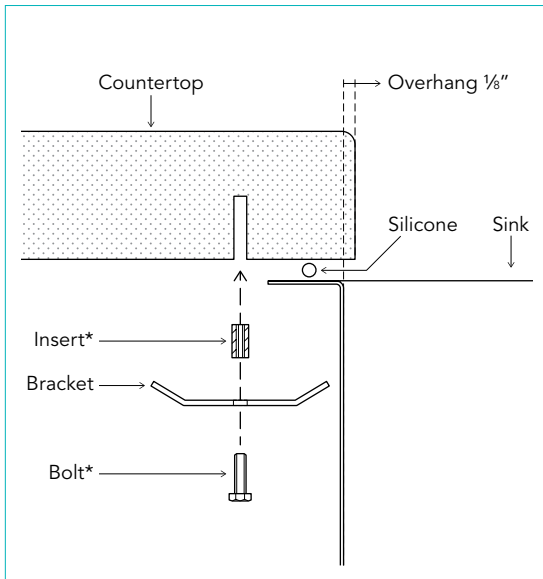

B. Countertop made of granite, quartz, marble or other stone surface on a wood base

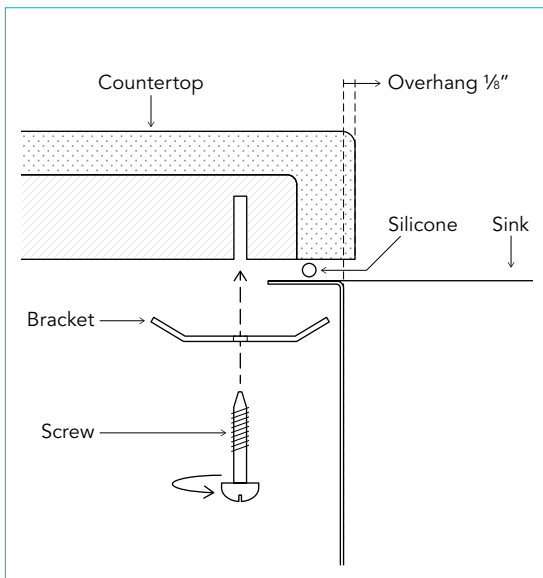

* Not included

Maintenance

Follow one simple rule to keep your sink in good condition:
Clean it regularly.

Daily

Clean the sink with a sponge or a soft cloth.

Use mild soap (dish soap) or an all-purpose, non-abrasive liquid cleanser that contains no chlorines or acid.

Always rinse with warm water and wipe with a dry cloth to prevent calcium buildup.

Use a bottom grid to protect the metal from wear and scratches.

Precautions

Do not scrub the sink with steel wool or scouring pads.

Do not use abrasive cleansers or products containing chlorines or acid.

Do not use silver polish or grout cleaning products, which can discolor the finish and leave stains.

Use a water and vinegar solution to loosen calcium buildup.

Mustard, mayonnaise, lemon juice, grease, fat, and other food residue can cause rust and stains if left to sit. Be sure to rinse your sink with plenty of water.

Do not place a rubber mat on the bottom of your sink. Food, water, and cleaning products can cling to it and create stains.

Warranty

Prochef offers a LIMITED LIFETIME WARRANTY on the fixed components of its stainless steel sinks. This warranty is limited to defects or damages resulting from a normal residential use. For further details on our product warranty, please refer to our catalog or Website.

CONCETTO
Single-Handle Kitchen Faucet
MODEL # 32665003

Pure Freude
an Wasser

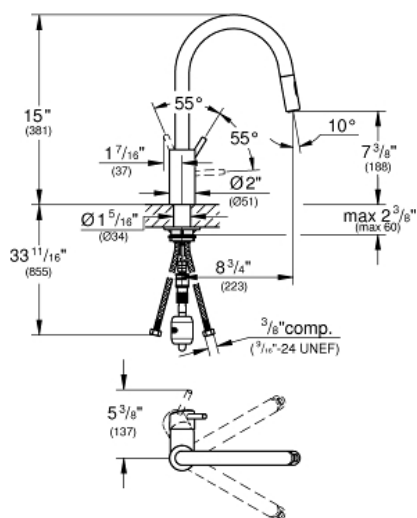

ADA



Product Description:
CONCETTO
Single-Handle Kitchen Faucet

Standard Specification:

- High spout
- Single hole installation
- **GROHE SilkMove** 1.4" (35 mm) ceramic cartridge
- **GROHE StarLight** chrome finish
- **GROHE EasyDock** guarantees easy retraction and smooth docking back to the starting position
- GROHE Zero isolated inner water ways - lead and nickel free
- Pull-out dual spray
- Swivel spout
- Integrated non-return valve
- Check valve included to prevent backflow
- Stainless steel flex lines
- Quick installation system
- Max Flow Rate: 1.75 gpm (6.6 L/min)
- GROHE Limited Lifetime Warranty

Applicable Codes & Standards:

- Energy Policy Act of 1992
- NSF 61
- ASME A112.18.1/CSA B125.1
- US Federal and State material regulations
- ICC/ANSI A117.1
- CalGreen
- NSF 372
- MASS

Color:

- 32665003 StarLight Chrome

003972 | J7®

UNDERMOUNT STAINLESS STEEL UTILITY SINK

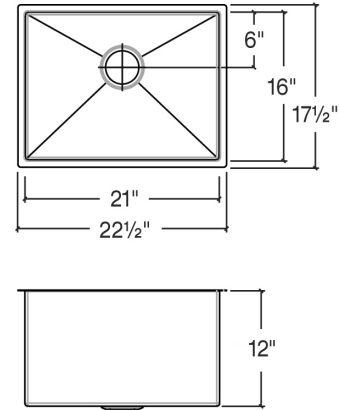

Specifications

Model	003972
Collection	J7®
Bowl dimensions	21" × 16" × 12"
Overall dimensions	22 1/2" × 17 1/2" × 12"
Recommended cabinet	27"

Recommended accessories

Drain	100082
Grid (coming soon)	200906
Colander	205223
Bin	205226
Tray	205232
Cutting board	210063
Drying Rack	215206

Features

- Handcrafted in Canada
- Commercial quality stainless steel - 16 ga thickness
- Corrosion resistant material - 304 series (18/10)
- Environmentally friendly product, 100% recyclable
- Elegant no. 4 brushed finish that matches the appliances
- Highly efficient sound deadening pads
- Practical flat sink bottom and straight bowl sides that maximize available space in the bowl
- Stylish and functional bowl bottom grooves that facilitate water drainage
- Rear 3-1/2" drain placement
- Mounting hardware and cutout template included
- Certifications: ASME A112.19.3, CSA B45.0, CSA B45.4

Warranty

Home Refinements offers a LIMITED LIFETIME WARRANTY on the fixed components of its stainless steel sinks against defects of material and workmanship. For further details on our product warranty, please refer to our catalog or Web site.

PORCELANOSA®

TILE · KITCHEN · BATH · HARDWOOD

[Home](#) > TONO: Rib handle single control lavatory faucet



TONO: Rib handle single control lavatory faucet

[Read/Write a Review](#)

Available Sizes

0"

Product Code

N122030063-100225000

Product Information

- Rib handle single control lavatory faucet
- Without pop-up drain
- 4 3/8
- Plus aerator
- Flexible connections for easy installation

Component Description

- **[N122030063-100225000]** MONOM TONO LAVABO MANETA ESTRIADA CR

[REVIEWS](#)

[Be the first to review this product](#)

Model: LAV. SOTTO BAJO ENC BL
Codes: 100120592 - N396990867
Group: G-0
Format: 17 29/32" X 13 3/8" approx.



FEATURES		
PACKING		
Pallets	35 ST/PAL	
Sale unit	ST	
Base unit	ST	
Net weight	17,09 LB/ST	
Gross weight	18,74 LB/ST	

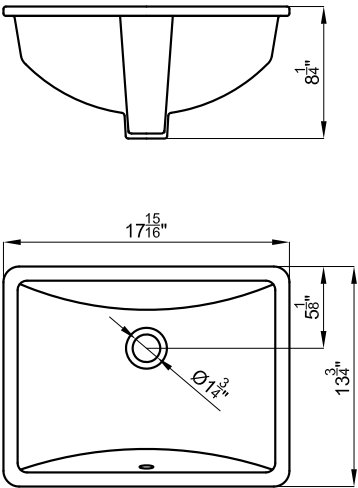

N111390022
100104972

PARTE EXT. BELA TERM. 3 M. 3 SAL.

Codes: 100104972 - N111390022
Model: USA PARTE EXT. BELA TERM.3 M.3 SAL.



GENERAL FEATURES		
Installation	SHOWER	
Feature - a	BUILT-IN	
Feature - b	THERMOSTATIC MIXER	
Family	URBAN	

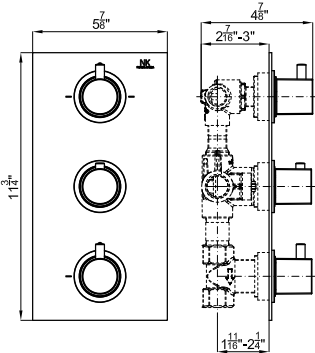

SPEAKMAN® S-2251

Icon Shower Head

FEATURES:

- 8 plungers, 64 sprays
- Solid brass construction
- Spray adjusting handle
- 1/2 in. NPT inlet
- Patented plungers resist scale buildup
- 2.5 gpm (9.5 L/min) flow rate

FINISH:



COMPLIANCE:

- ASME A112.18.1/CSA B125.1 compliant

WARRANTY:

- Limited Lifetime Warranty (consumer use)
- 1 Year Limited (commercial use)



DIMENSIONS:

NOTE: 1. All dimensions are in inches (millimeters) unless otherwise specified and are subject to change without notice.

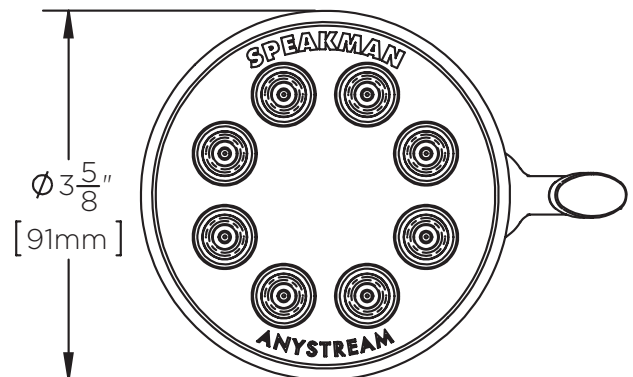
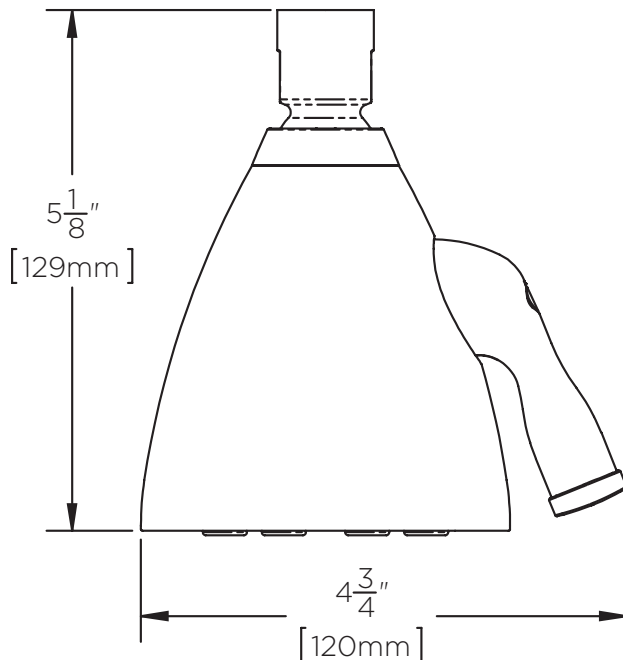

Architect/Engineer Approval Space:

SPEAKMAN
400 ANCHOR MILL ROAD
NEW CASTLE, DE 19720

P: 800-537-2107
F: 800-977-2747
W: WWW.SPEAKMAN.COM
R: JUNE 2015



Schluter®-KERDI-DRAIN

GRATES FOR USE WITH FLANGES WITH 2" OUTLET

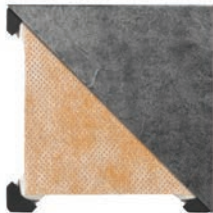

4" (100 mm) Grate

Tileable grate



Tileable grate
Item No.
KD4 GRK ECS

Patent pending

Contents		
	1x Tileable covering support	
		1x Spacer
		
		1x Lateral adjustment ring

GRATES FOR USE WITH FLANGES WITH 2" or 3" OUTLET

6" (150 mm) Grate



Stainless steel



Stainless steel - 6" square
Item No.
KD6 GRK E



Stainless steel - 6" round
Item No.
KD6 GRK RE

Contents	
	1x Grate and frame with integrated height adjustment collar
	1x Lateral adjustment ring

Model: USA PACK INOD. OP ARQUITEC ASI. UF

Codes: 100111657 - N301512843



GENERAL FEATURES		
Installation	PAN WITH CLOSE COUPLE (1 PIECE)	
Family	ARQUITEC	
Certifications	CAL_GREEN	
Certifications	CSA	
Certifications	HET	
Certifications	MASSACHUSETS	
Certifications	WATERSENCE	

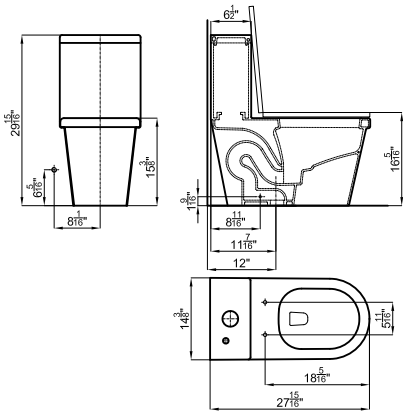

Codes: 100144945 - N199999424

Model: USA PACK DUCHA MOOD



GENERAL FEATURES		
Installation	SHOWER	
Feature - a	SHOWER PACK	
Family	MOOD	
Certifications	CUPC	
Certifications	MASSACHUSETTS	
Designer	RICHARD ROGERS & LUIS VIDAL	

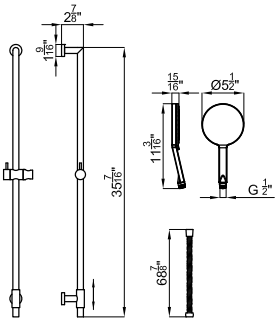

PORCELANOSA®

TILE · KITCHEN · BATH · HARDWOOD

[Home](#) > TONO: External part wall-mount single control faucet



TONO: External part wall-mount single control faucet

[Read/Write a Review](#)

Available Sizes

0"

Product Code

N122030058-100224921

Product Information

- External part wall-mount single control faucet
- Without pop-up drain
- 7 1/2 spout reach
- Plus aerator
- Flow rate 1.5 gpm@60 PSI
- Internal body required (100224930-N122030060)

Component Description

- **[N122030058-100224921]** P EXT MON. PARED TONO LAV. CANO CUAD.

[REVIEWS](#)

N386000011
100104499

PULS. FRONT. DOBLE SMART LINE CRYSTAL BL

noken
PORCELANOSA Grupo

Model: PULS. FRONT.DOBLE SMART LINE CRYSTAL BL

Codes: 100104499 - N386000011



GENERAL FEATURES		
Installation	INSTALLATION SYSTEMS	
Feature - a	FLUSH BUTTONS	
Family	SMART LINE	

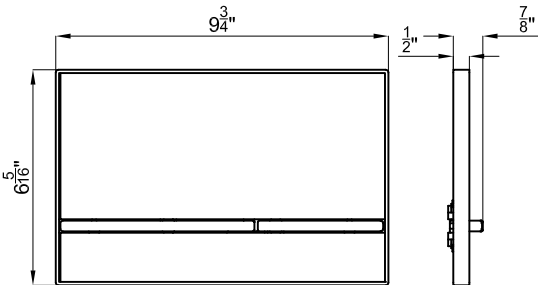

N390000046
100144090

INODORO SUSP. ARQUITECT

noken
PORCELANOSA Grupo

Model: INODORO SUSP. ARQUITECT USA

Codes: 100144090 - N390000046



GENERAL FEATURES		
Installation	WALL HUNG PAN	
Family	ARQUITECT	
Certifications	CSA	
Certifications	WATERSENCE	
Certifications	MASSACHUSETTS	

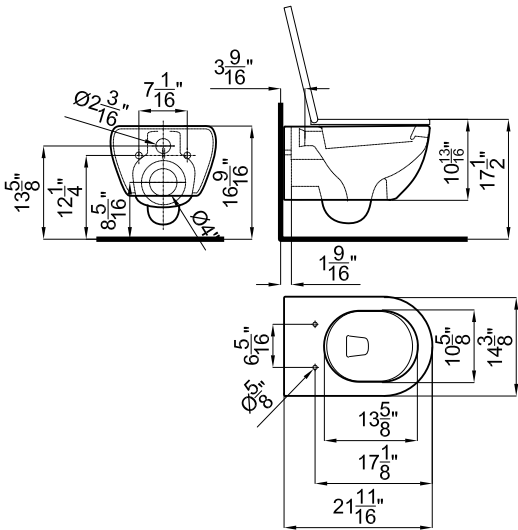

Codes: 100179945 - N199999305

Model: USA MONM.LOUNGE LAV. TITANIO



GENERAL FEATURES

Feature - a	DECK MOUNTED	
Installation	BASIN	
Feature - b	SINGLE LEVER MIXER	
Family	LOUNGE	
Certifications	CSA	
Designer	SIMONE MICHELI	

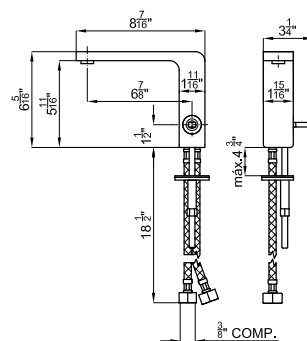



Verticyl® Rectangle

Under-mount Bathroom Sink
K-2882

Features

- Geometric rectangular basin with vertical sides.
- Overflow drain.
- No faucet holes; requires wall- or counter-mount faucet.

Material

- Vitreous china.

Installation

- Under-mount

Recommended Products/Accessories

K-8998 P-Trap

Included Components

Additional Components:
1193643 Basin Clamps



ADA

Codes/Standards

ASME A112.19.2/CSA B45.1

ADA











ICC/ANSI A117.1

KOHLER® One-Year Limited Warranty

See website for detailed warranty information.

Available Colors/Finishes

Color tiles intended for reference only.

Color	Code	Description
	0	White
	HW1	Honed White
	96	Biscuit
	47	Almond
	NY	Dune
	95	Ice™ Grey
	G9	Sandbar
	33	Mexican Sand™
	K4	Cashmere
	58	Thunder™ Grey
	7	Black Black™

1-800-4KOHLER (1-800-456-4537)

Kohler Co. reserves the right to make revisions without notice to product specifications.

For the most current Specification Sheet, go to www.kohler.com.

4-25-2019 20:31 - US/CA/MX

THE BOLD LOOK
OF **KOHLER**®



Verticyl® Rectangle

Under-mount Bathroom Sink

K-2882

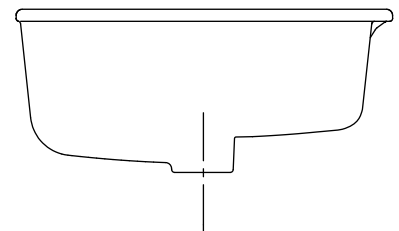
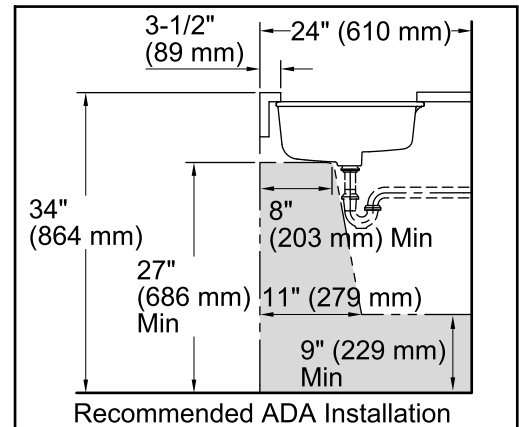
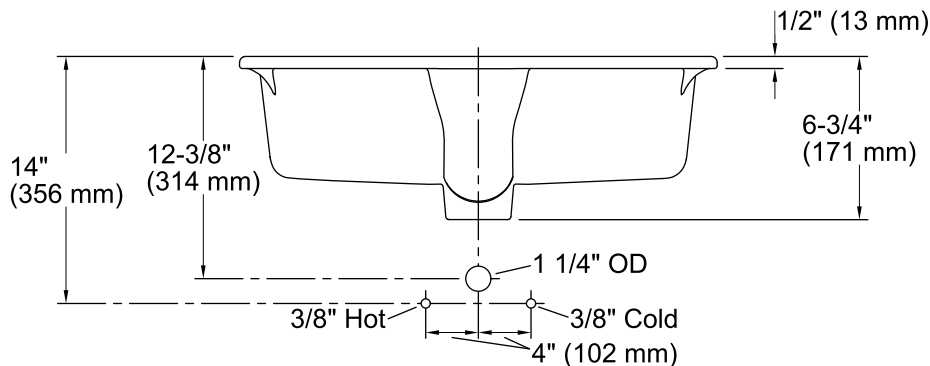
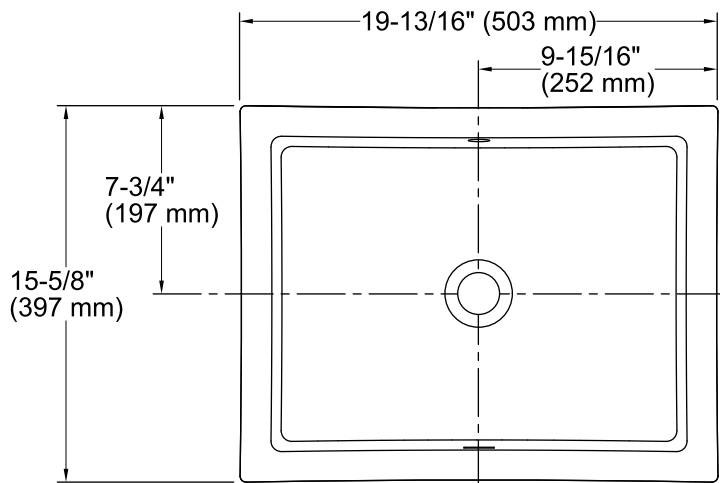

Technical Information

All product dimensions are nominal.

Bowl configuration: Single

Installation: Under-mount

Bowl area (Only): Length: 17-1/4" (438 mm)
Width: 13" (330 mm)
Water depth: 3-1/8" (79 mm)

Drain hole: 1-3/4" (44 mm)

Template: 1109226-7, required, not included

Notes

Install this product according to the installation instructions.

NOTICE: Countertop manufacturer or cutter must use the current product template available at www.kohler.com, or by calling 1-800-4KOHLER. Kohler Co. is not responsible for cutout errors when the incorrect cutout template is used.

ADA compliant when installed to the specific requirements of these regulations.

Codes: 100158886 - N112080006

Model: USA PACK DUCHA NKCONCEPT C/TOMA AGUA CR.



GENERAL FEATURES

Installation	SHOWER	
Feature - a	SHOWER PACK	
Family	NK CONCEPT	
Certifications	CSA	
Certifications	MASSACHUSETTS	

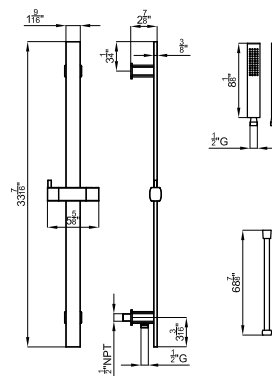

N199999283
100179980

PARTE EXT. MEZ. TERM. LOUNGE 3/4 TITAN

noken
PORCELANOSA Grupo

Codes: 100179980 - N199999283
Model: USA PARTE EXT.MEZ.TERM.LOUNGE 3/4" TITAN



GENERAL FEATURES		
Feature - b	THERMOSTATIC MIXER	
Feature - a	BUILT-IN	
Installation	SHOWER	
Family	LOUNGE	

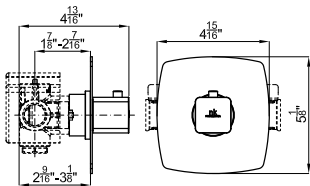

N199999282
100179967

PARTE EXT. LLAVE P. LOUNGE 3/4" TITAN

noken
PORCELANOSA Grupo

Codes: 100179967 - N199999282
Model: USA PARTE EXT.LLAVE P. LOUNGE 3/4" TITAN



GENERAL FEATURES		
Feature - a	BUILT-IN	
Installation	SHOWER	
Feature - b	STOP VALVE	
Family	LOUNGE	

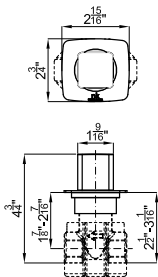



Schluter®-KERDI-LINE

GRATE ASSEMBLY - CHROME

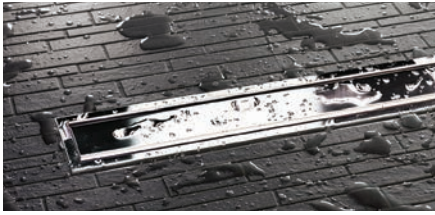

Closed (A)

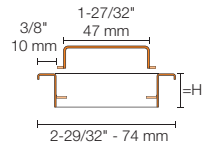

Perforated (B)

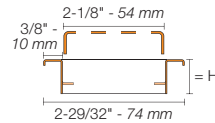

Grate assemblies - Chrome



3/4" (19 mm) frame height for
1/8" to 9/16" (3 mm to 15 mm) -thick coverings

Length = in. - cm	Closed (A)	Perforated (B)
	Item No.	Item No.
19-11/16 - 50	KL1AR 19 EP 50	KL1B 19 EP 50
23-5/8 - 60	KL1AR 19 EP 60	KL1B 19 EP 60
27-9/16 - 70	KL1AR 19 EP 70	KL1B 19 EP 70
31-1/2 - 80	KL1AR 19 EP 80	KL1B 19 EP 80
35-7/16 - 90	KL1AR 19 EP 90	KL1B 19 EP 90
39-3/8 - 100	KL1AR 19 EP 100	KL1B 19 EP 100
43-5/16 - 110	KL1AR 19 EP 110	KL1B 19 EP 110
47-1/4 - 120	KL1AR 19 EP 120	KL1B 19 EP 120



Frameless Tileable (D)

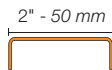

Grate assemblies - Frameless tileable

Length = in. - cm	Item No.	
	Frameless Tileable (D)	
	For use with center outlet channel body	For use with off-set outlet channel body
19-11/16 - 50	KL1DRE 50	-
23-5/8 - 60	KL1DRE 60	-
27-9/16 - 70	KL1DRE 70	KL1DRO E 70
31-1/2 - 80	KL1DRE 80	KL1DRO E 80
35-7/16 - 90	KL1DRE 90	KL1DRO E 90
39-3/8 - 100	KL1DRE 100	KL1DRO E 100
43-5/16 - 110	KL1DRE 110	KL1DRO E 110
47-1/4 - 120	KL1DRE 120	KL1DRO E 120
51-3/16 - 130	KL1DRE 130	-
55-1/8 - 140	KL1DRE 140	-
59-1/16 - 150	KL1DRE 150	-
62-15/16 - 160	KL1DRE 160	-
66-7/8 - 170	KL1DRE 170	-
70-13/16 - 180	KL1DRE 180	-

N199999463
100143737

MONM. LOUNGE B. D. PAV. CROMO

noken
PORCELANOSA Grupo

Codes: 100143737 - N199999463
Model: USA MONM.LOUNGE B.D.PAV.CROMO



GENERAL FEATURES		
Installation	BATH	
Feature - a	FLOOR MOUNTED	
Family	LOUNGE	
Certifications	CSA	
Certifications	MASSACHUSETTS	
Designer	SIMONE MICELI	

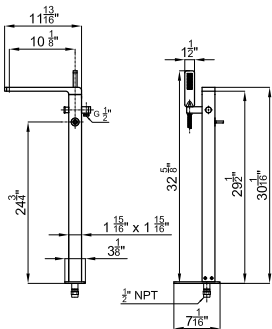

61" LEITH

ACRYLIC FREESTANDING TUB

SKU: 920161

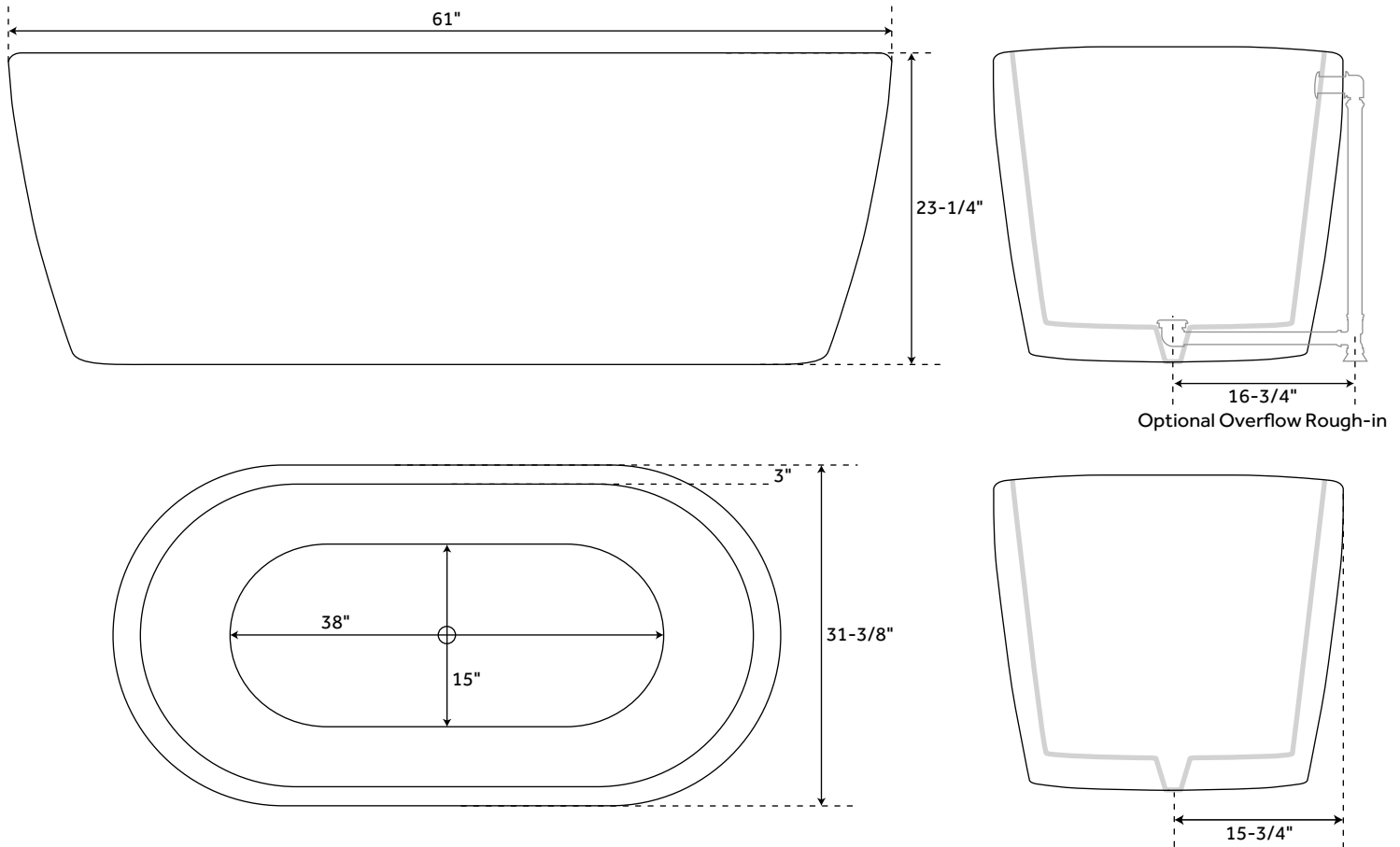

FEATURES

Product Finish: White
Overflow Hole: Optional
Shape: Oval
Material: Acrylic
Tap Deck: No
Drain Included: Optional
Drain Placement: Center
Faucet Included: No
Faucet Drillings: No Drillings
Built-In Adjusters: Yes
Water Capacity Without/With Overflow
(Gallons): 46/39
Water Depth Without/With Overflow:
18-1/2"/15-3/4"
Tub Weight Uncrated (lbs): 99
Tub Weight Crated (lbs): 209

SIGNATURE HARDWARE LIFETIME WARRANTY

See website for warranty information



All measurements are approximate. Measurements may vary +/- 1/2".

REVISED 03/14/2019

Codes: 100141295 - N194710566

Model: USA HOTELS PB



GENERAL FEATURES		
Installation	SHOWER	
Feature - b	PRESSURE BALANCER	
Family	HOTELS	
Feature - a	BUILT-IN	
Certifications	CSA	
Certifications	MASSACHUSETTS	
Certifications	ADA_COMPLY	

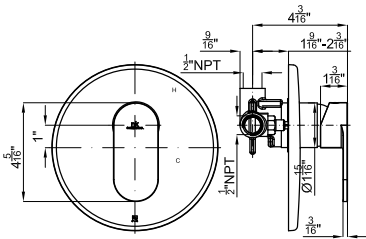

N299998565
100229055

ROUND CAÑO BAÑERA CROMO

noken
PORCELANOSA Grupo

Codes: 100229055 - N299998565
Model: USA ROUND CAÑO BAÑERA CROMO



GENERAL FEATURES		
Family	ROUND	
Feature - a	BUILT-IN	
Feature - b	SPOUT	
Installation	BATH	
Certifications	CUPC	

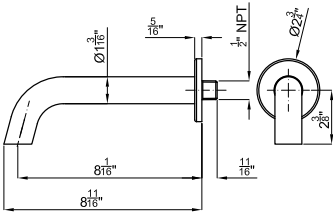

N194710571
100144867

HOTELS PB CON INVERSOR NIQUEL

noken
PORCELANOSA Grupo

Codes: 100144867 - N194710571
Model: USA HOTELS PB CON INVERSOR NIQUEL



GENERAL FEATURES		
Installation	SHOWER	
Feature - a	BUILT-IN	
Feature - b	PRESSURE BALANCER	
Family	HOTELS	
Certifications	CSA	
Certifications	MASSACHUSETTS	

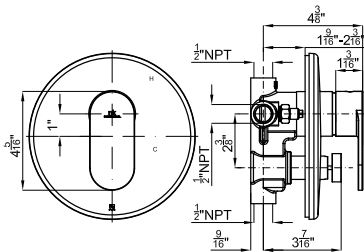



Features integral skirting and tile flange.

Designer Collection Tubs
Model # 151

Cameron 1

60" x 32" x 20.625"

GENERAL SPECIFICATIONS:

Material - Acrylic

Installation - Alcove

Plumbed Weight - 130 lbs / 59 kg

Soaker Weight - 105 lbs / 48 kg

Average Fill - 30 gal to above jet level

Maximum Fill - 57 gal to overflow

NOTE: Filling this tub to the maximum may require an above average size or dedicated water heater.

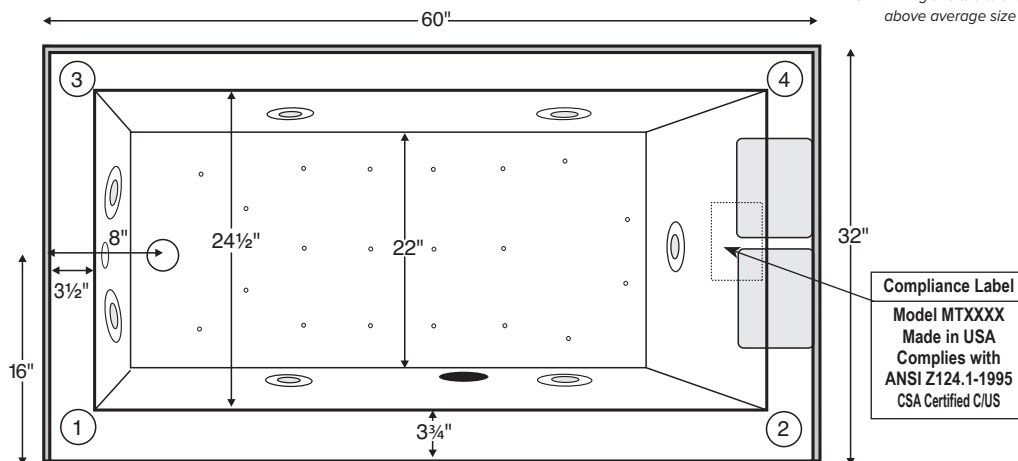

Numbered areas on tub deck represent possible locations to install cleaning systems, faucets and other fixtures.
Shown with Air Massage and Ultra Whirlpool Package.

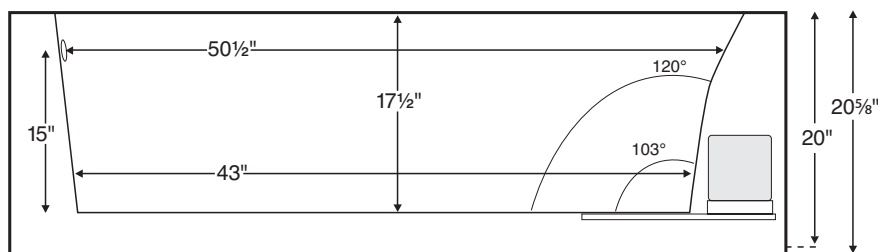

ELECTRICAL COMPONENTS & SPECIFICATIONS

Required Electrical Service - 110 Volt

Hydrotherapy Package	Components Included	GFCI
Standard Whirlpool	2-bhp pump	1-15 amp
Ultra Whirlpool	2 2-bhp pumps, inline heater	2-20 amp
Air Massage	heated blower	1-15 amp
Air Massage Elite	heated blower, chromatherapy	1-15 amp
Air Massage with Standard Whirlpool	2-bhp pump, heated blower	2-15 amp
Air Massage with Ultra Whirlpool	2 2-bhp pumps, inline heater, heated blower	2-20 amp
Air Massage Elite with Standard Whirlpool	2-bhp pump, heated blower, chromatherapy	2-15 amp
Air Massage Elite with Ultra Whirlpool	2 2-bhp pumps, inline heater, heated blower, chromatherapy	2-20 amp

For electrical requirements of tub options, see specific options specs
CSA Certified C/US; ANSI Z124.1 for plastic tubs and ANSI 112.19.7 for whirlpool components.

IMPORTANT ORDERING & INSTALLATION INFORMATION:

- Before ordering or installing, please consider future access to equipment.
- Cameron includes integral front skirting, tile flange on 3 sides and a pre-leveled foam base to facilitate the installation process.
- Tub is available with a left- or right-hand drain location. Must specify on order.
- Overall standard tub height is 20.625", but can be reduced by as low as 20" ONLY when ordered as a soaker. Must specify on order.
- Radiance placed on floor locations will affect placement of air jets.
- Skirting is non-removable and provides no access. Must have end access for servicing of equipment.
- If you plan to use a glass enclosure, MTI must be advised when ordering for possible relocation of systems controls.
- Suction and control locations may vary.
- Specifications and configurations are subject to change without notice.
- Measurements are $\pm 1/2$ " and are subject to change without notice.
- Measurements herein supersede all others published prior to publication date shown below.













See the "Designer Collection Tubs Installation & Operation Manual" included with tub delivery or go to mtibaths.com/support/installation_operation/manuals for all the information necessary to install and operate the tub.

MTI's Customer Service Department is available Monday-Friday 8am-6pm EST at 800-783-8827 or customerservice@mtibaths.com to answer any questions pertaining to ordering or installation.



Packages and Pricing

For more information on any of the following packages, please visit: mtibaths.com/therapies-for-wellness/

Hydrotherapy Packages	Package Contents	Part #	MSRP
 Soaker	Soaking bath - no jets; features integral skirting (no front access), integral tile flange, pre-leveled foam base Note: Overall tub height can be reduced by .625" for soakers only. Must specify on order.	S151	\$1,740
 Stream Bath	6 side vents, 2 end vents, 1-bhp pump integral skirting (no front access), integral tile flange, pre-leveled foam base	SM151	\$3,590
 Air Massage	20 air jets, heated air blower, Aromatherapy, integral skirting (no front access), integral tile flange, pre-leveled foam base	AST151	\$4,555
 Air Massage Elite	30 air jets, heated air blower, Aromatherapy, Chromotherapy LED lighting, Spa Mode, integral skirting (no front access), integral tile flange, pre-leveled foam base	AE151	\$6,285
 Stream Bath with Air Massage	6 side vents, 2 end vents, 1-bhp pump, 20 air jets, heated air blower, Aromatherapy, integral skirting (no front access), integral tile flange, pre-leveled foam base	ASTSM151	\$6,405
 Stream Bath with Air Massage Elite	6 side vents, 2 end vents, 1-bhp pump, 30 air jets, heated air blower, Aromatherapy, Chromotherapy LED lighting, Spa Mode, integral skirting (no front access), integral tile flange, pre-leveled foam base	AESM151	\$8,135
 Standard Whirlpool	5 point-massage jets, 2-bhp pump, integral skirting (no front access), integral tile flange, pre-leveled foam base	P151	\$3,385
 Ultra Whirlpool	7 point-massage jets, 2-bhp pump, inline heater, Ozone, integral skirting (no front access), integral tile flange, pre-leveled foam base	P151U	\$4,600
 Air Massage with Standard Whirlpool	5 point-massage jets, 2-bhp pump, 20 air jets, heated air blower, Aromatherapy, integral skirting (no front access), integral tile flange, pre-leveled foam base	AW151	\$6,160
 Air Massage with Ultra Whirlpool	7 point-massage jets, 2-bhp pump, inline heater, 20 air jets, heated air blower, Aromatherapy, Ozone, integral skirting (no front access), integral tile flange, pre-leveled foam base	AU151	\$7,055
 Air Massage Elite with Standard Whirlpool	5 point-massage jets, 2-bhp pump, 30 air jets, heated air blower, Aromatherapy, Chromotherapy LED lighting, Spa Mode, integral skirting (no front access), integral tile flange, pre-leveled foam base	AEAP151	\$7,580
 Air Massage Elite with Ultra Whirlpool	7 point-massage jets, 2-bhp pump, inline heater, 30 air jets, heated air blower, Aromatherapy, Chromotherapy LED lighting, Spa Mode, Ozone integral skirting (no front access), integral tile flange, pre-leveled foam base	AEAP151U	\$8,545

Lead Time - Soakers, Stream Bath and Whirlpool Packages - 5 business days
Air Baths and Combo Packages - 7 business days

NOTES: • Aromatherapy is eliminated for undermount applications
• Air Baths, Pre-Leveled Foam Base or Frame Systems increase overall height by 2-3".

RECOMMENDED SENSORY THERAPIES

SEE NEXT PAGE FOR AN OVERVIEW OF AVAILABLE OPTIONS.



Chromotherapy
Underwater lighting is provided by digitally controlled LEDs. Different colors are thought to have different therapeutic effects.

LE - \$610



Audiotherapy
Stereo H₂O lets you "feel" the music through the bath water. Available with Bluetooth system or transducers with leads to connect to an external system.

STEREOH202 - \$1,135
STEREOBT - \$1,235



Thermotherapy
Radiance uses integrated radiant heat to warm the backrest for neck, shoulders and back. Inline heaters maintain bath water temperature.

RAD100 - \$1,080
HTISOAK - \$750



Microbubbles
For wellness and beauty, billions of the tiniest air bubbles saturate the water with dissolved oxygen to moisturize and soften the skin. Available for soakers and air baths.

MICRO - \$1,745



Options and Pricing

For more information on any of the following options, please visit: mtibaths.com/tub-options/

Premium Options

NOTE: part codes for all options listed in parenthesis.

Microbubbles - Available on Soakers and Air Baths only
(MICRO) **\$1,745**
System components may extend up to 5" beyond perimeter of the tub.

Radiance - integrated tub shell heating system
(RAD100) **\$1,080**

Chromatherapy - Included in some hydrotherapy packages
underwater LED lighting (LE) **\$610**

Stereo H₂O - Standard System - includes 4 integrated audio transducers
with leads to connect to an external audio source
(STEREOH202) **\$1,135**
Bluetooth System - integrated Bluetooth system allows you
to directly connect to an applicable device
(STEREOBT) **\$1,235**

Standard Options

Standard Colors: White (CWH), Bone (CBN), Biscuit (CBS)
Color Upgrade: (COL2) **\$500**, please call for availability of special colors

Quick Ship - reduces lead time - please call for availability
(QSPRI) **\$380**

Textured, Slip-Resistant Bottom - meets ASTM F-462-1994
(TXBTM) **\$75**

Virtual Spout - high-flow integrated tub filler
(FPMJ) **\$310**

Inline Heater - included in some hydrotherapy packages
For whirlpools or Stream Bath (HTI) **\$545**
Uses existing pump
Soaker or Air Baths (HTISOAK) **\$750**
Includes a recirculating pump.

Accessories & Hardware for All Packages

Drain Kits - other finishes also available

Toe-Tap with Slim-Line Integrated Overflow

Choose from: Chrome (SLOT), Brushed Nickel (SLOTBN),
Polished Nickel (SLOTPN) or White (SLOTWH) **\$390**

Toe-Tap with Rectangular Overflow -

Chrome (WOTRC) **\$285**
Brushed Nickel (WOTRBN) **\$290**
White (WOTRW) **\$290**

Toe-Tap with Round Overflow -

Chrome (WOTTC) **\$285**
Brushed Nickel (WOTTBN) **\$290**
Polished Nickel (WOTTPN) **\$340**

Cable Driven -

Chrome (WOCD) **\$315**
Brushed Nickel (WOCDBN) **\$385**
Polished Nickel (WOCDPN) **\$515**
Oil-Rubbed Bronze (WOCBOR) **\$515**

Lift & Turn -Chrome (WOC) **\$125**

Brushed Nickel (WOBN) **\$225**

Grab Bars - 9" Curved, set of 2

Acrylic - color-matched with tub
standard colors only (GB) **\$300**
Metal - Chrome (GBMCC), Brushed Nickel (GBMCBN) **\$330**

Pillows - from **\$125** See pillows pricing and specs online.

Teak Tub Tray - Slatted (TK-TRAY1) or Solid (TK-TRAY2) **\$415**

Teak Bath Mat (TK-MAT3018) **\$430** custom sizes also available

Accessories & Cleaning Systems for Whirlpool Packages

Trim Kits - must be ordered at time of purchase; other finishes available

Standard Whirlpool - Chrome (TRC) **\$235**; Brushed Nickel (TRBN) **\$595**
Ultra Whirlpool - Chrome (TRCU) **\$320**; Brushed Nickel (TRBNU) **\$815**

Pump Upgrade - 3-bhp (PUMP3) **\$245**

Additional Jet Options See jet options pricing and specs online.

Whirlpool Cleaning Systems -

Fill-Flush (FFSO) **\$590**; Simple Touch (FFE) **\$710**

Ozonator - bath water purification system (OZONE) **\$535**