

1 Existing Ground Floor Plan
Scale: 3/8" = 1'-0"

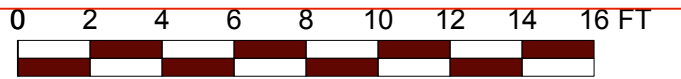

April , 2019

Print Date: _____

ELLIOTT ABRAMS
ARCHITECTURE CONSULTING DEVELOPMENT
LICENSE #C25555
1834 Fourth Street Berkeley, CA. 94710
(510) 644-3002 (510) 649-9095 fax

Residential Window Replacement for
Mr James Lau & Anita Wong
APN #30-1903-4
3661 Loma Vista Oakland, CA.

ABRAMS/MILLIKAN & ASSOC. expressly reserves their common law copyright and other property rights in these plans. These plans are not to be reproduced, changed, or copied in any form or manner whatsoever, nor are they to be assigned to a third party without first obtaining the written permission and consent of A.M.A. In the event of unauthorized reuse of these plans by a third party, the third party shall hold A.M.A. harmless.

DATE: April 2019

SCALE: 1/4"=1'-0"

DRAWN : EA

JOB:

REVISION	DATE	BY	CHECKED

SHEET NO.

A.1.0

OF _____ SHEETS

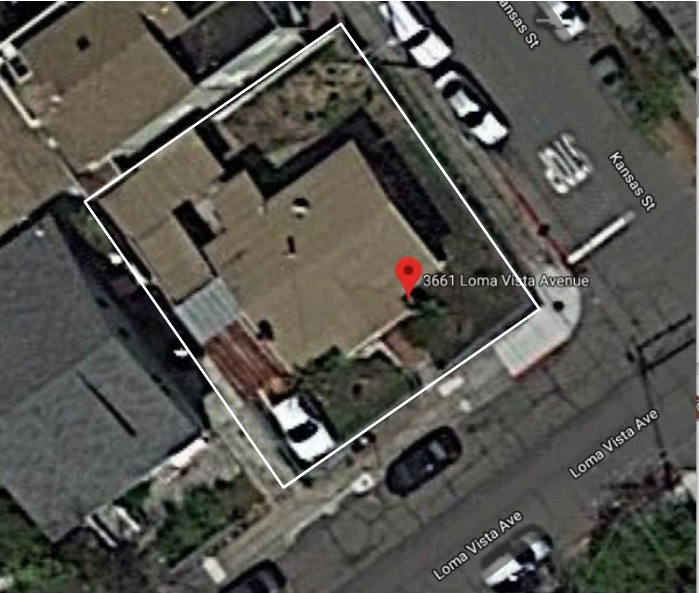

Overhead Site Plan



Front View from Loma Vista Ave.

DISCLAIMER: Field Measured
Do not Rely on as a Survey

Deemed Accurate
but not Guaranteed

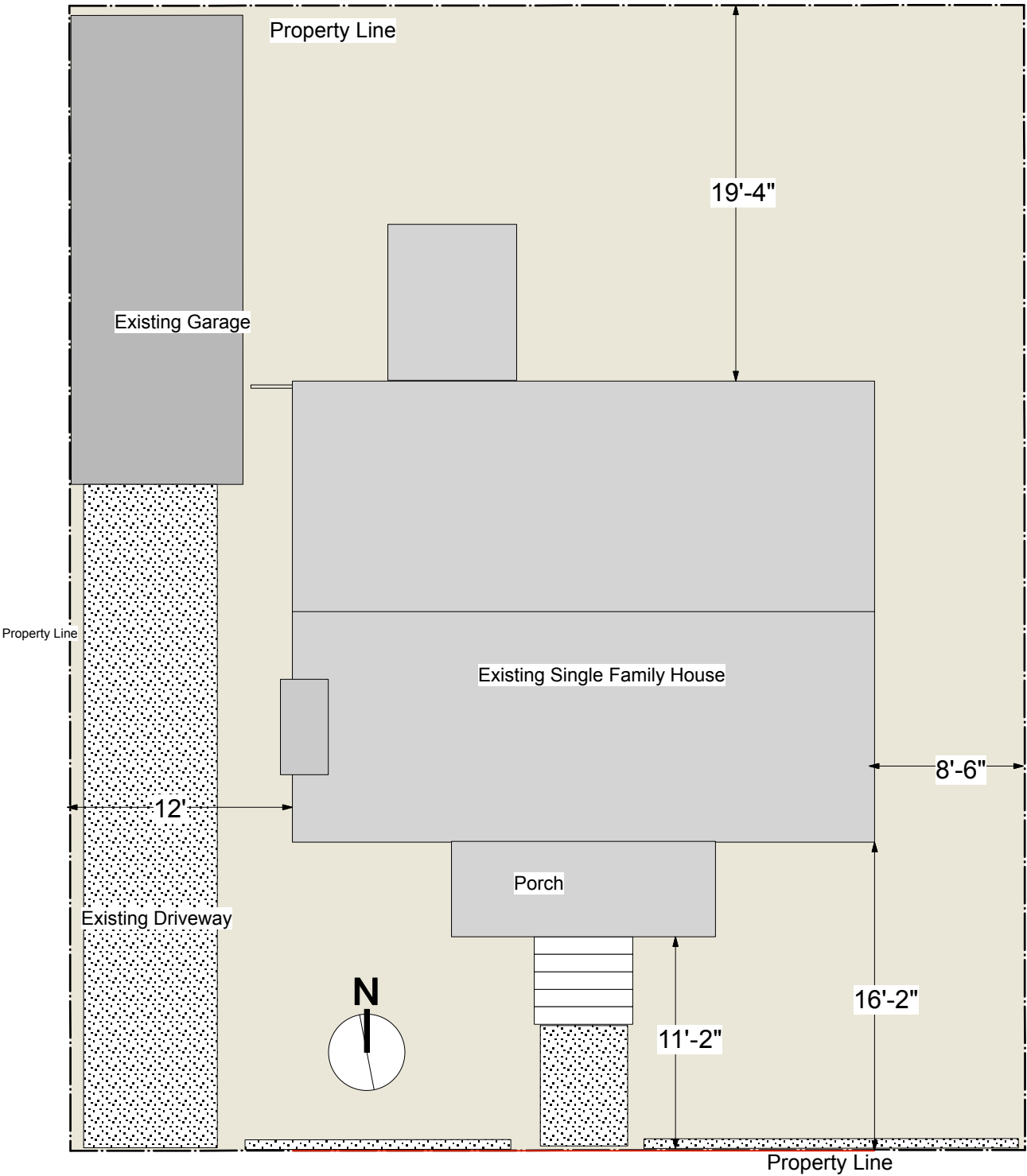

Loma Vista Avenue

Kansas Street

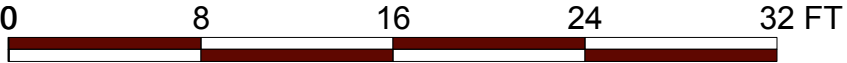

April , 2019

Print Date: _____

ELLIOTT ABRAMS
ARCHITECTURE CONSULTING DEVELOPMENT
LICENSE # 025565
1834 Fourth Street Berkeley, CA. 94710
(510) 644-3002 (510) 649-9095 fax

Residential Window Replacement for
Mr James Lau & Anita Wong
APN #30-1903-4
3661 Loma Vista Oakland, CA.

ABRAMS/MILLIKAN & ASSOC. expressly reserves their common law copyright and other property rights in these plans. These plans are not to be reproduced, changed, or copied in any form or manner whatsoever, nor are they to be assigned to a third party without first obtaining the written permission and consent of A.M.A. In the event of unauthorized reuse of these plans by a third party, the third party shall hold A.M.A. harmless.

DATE: April 2019

SCALE: 1/4"=1'-0"

DRAWN : EA

JOB:

REVISION	DATE	BY	CHECKED

SHEET NO.

A.1.0

OF SHEETS